

G5™ In A Box

3A9275D

EN

For dispensing NLGI Grades #000 to #2 greases and oil with at least 40cSt. For professional use only.

Not approved for use in explosive atmospheres or hazardous (classified) locations.

3000 psi (20.7 MPa, 207 bar) Maximum Working Pressure

See page 2 for model information, including maximum working pressure and approvals.



Important Safety Instructions

Read all of the instructions in this manual and all warnings and instructions in the G5 Pro Automatic Lubrication Pump manual before using the equipment. Save all instructions.

Related Manuals

Manual in English	Description
3A8847	G5 Standard Automatic Lubrication Pump
3A8848	G5 Pro Automatic Lubrication Pump

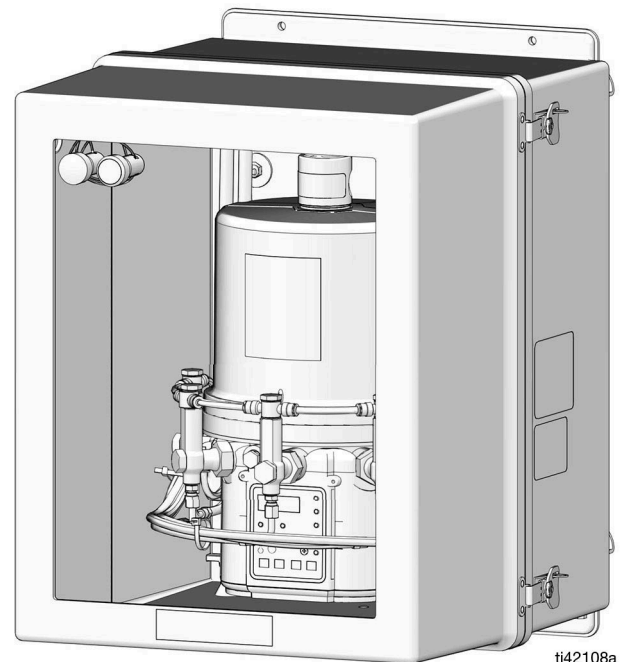

Models

Part No.	Maximum Working Pressure psi (MPa, bar)	Description	Includes:
			Pump
134010	3000 (20.7 MPa, 207 bar)	Pump, G5 In A Box, PRO, with PRV	95G105
134011	3000 (20.7 MPa, 207 bar)	Pump, G5 In A Box, PRO, with AFSSO and PRV	95G108
134410	3000 (20.7 MPa, 207 bar)	Pump, G5 In A Box, STD, with PRV	95G102
134411	3000 (20.7 MPa, 207 bar)	Pump, G5 In A Box, STD, with PRV and Return	95G102
2002147	3000 (20.7 MPa, 207 bar)	Pump, G5 In A Box, STD, with AFSSO and PRV	95G115

Installation

1. Select a location strong enough to support the weight and stress of operation to mount the G5 In A Box.
2. Mount two (2) of the brackets (104a) to the support location with user supplied hardware. Refer to **Dimensions**, starting on page 8.
3. Connect isolators (104e) to the brackets (104a), using the M8-1.25x20 bolts (104f) and the M8-125 lock nuts (104c) and torque to 200 in-lb (22.6 N•m) (FIG. 1).

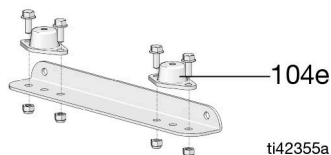
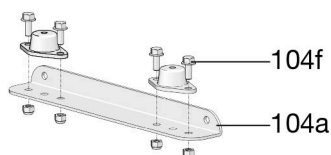

FIG. 1

NOTE: For the G5 in A Box with AFSSO, skip step 4, and go to step 5.

4. Mount the remaining brackets (104a) to the G5 In A Box enclosure, using M8-1.25x30 bolts (104b) and M8-1.25 lock nuts (104C) and torque to 200 in-lb/ (22.6 N•m) (FIG. 2).

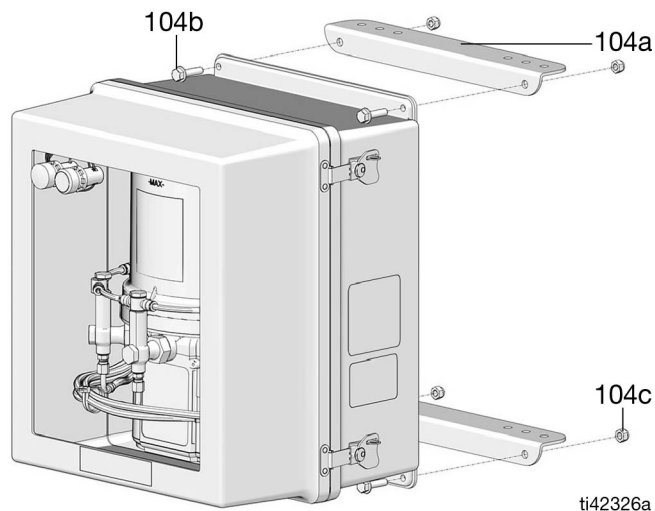

FIG. 2

5. Mount the remaining brackets(104a) to the G5 In A Box, through the inside of the enclosure, using M8-1.25x30 bolts (104b), and M8-1.25 lock nuts (104C), and fender washers (104d) and torque to 200 in-lb (22.6 N•m) (FIG. 3).

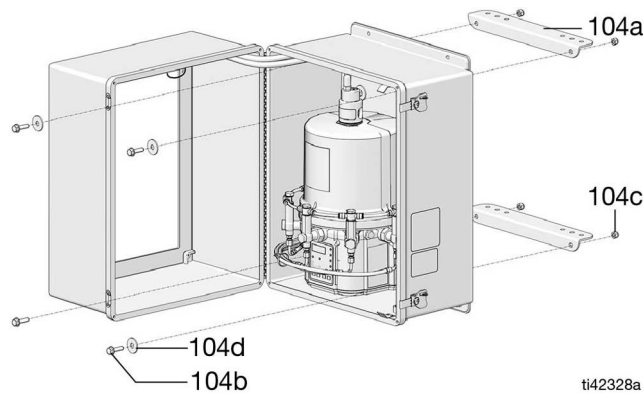

FIG. 3

6. Attach the G5 In A Box to the mounted isolators, using M8-1.25x20 bolts (104f), and torque to 200 in-lb (22.6 N•m) (FIG. 4).

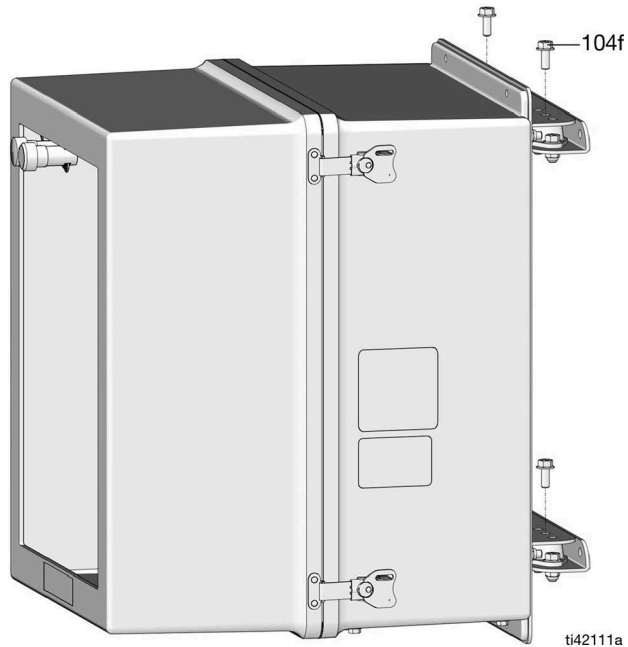

FIG. 4

7. Connect the outlets to the lubrication points.
8. **Models 134010 And 134011:** Wire the G5 pump to a fused power source following the instructions in the G5 Pro Automatic Lubrication Pump (see **Wiring**, page 5).

Models 134410 And 134411: Run cable power (101a) through the enclosure and grommet (141) following the wiring instructions in the G5 Standard Automatic Lubrication Pump (see **Related Manuals**, page 1).

9. Load the G5 pump with fluid through the fill port following the warnings and instructions from the G5 Pro Automatic Lubrication Pump (see **Related Manuals**, page 1), being careful not to overfill the reservoir.

NOTE: The fill level is located on the front of the pump reservoir.

10. Connect the 1/8 npt outlets of the manifold (103) to the lubrication points.

Operation

Models 134410 And 134411

Follow the instructions in the G5 Standard Automatic Lubrication Pump (see **Related Manuals**, page 1).

Models 134010 And 134011

For information on programming the G5 pump, refer to G5 Pro Automatic Lubrication Pump manual (see **Related Manuals**, page 1). Follow the instructions in the **Indicator Lights** section.

Indicator Lights

Reference FIG. 5 for this section.

1. The red button illuminates while power is supplied to the pump.
2. Pushing the red button while illuminated, activates the manual run function.
3. A solid green light illuminates during pump operation.
4. The green light flashes to indicate a fault. For information on clearing the fault, see the G5 Pro Automatic Lubrication Pump manual.

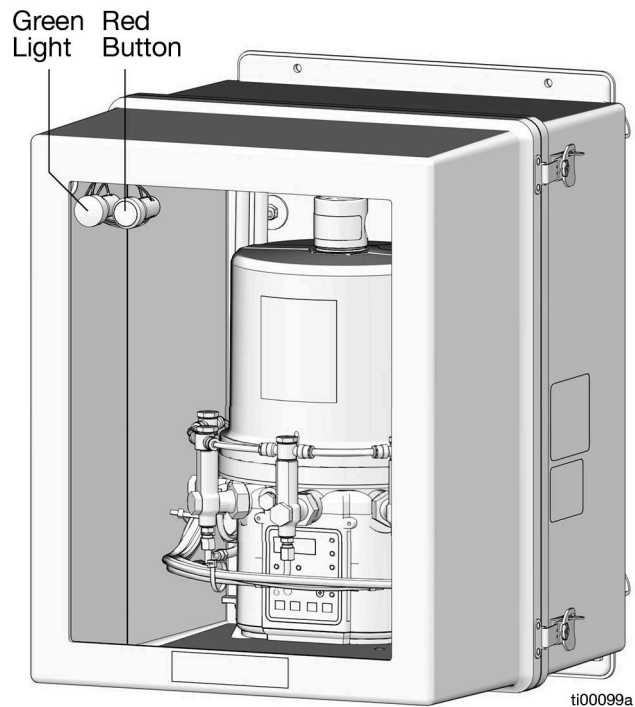

FIG. 5

Wiring

(Models 134010 and 134011)

Terminal Block 1

White 1
Red 1
Red 2
Red 3

Terminal Block 2

Black 1
Black 2
Black 3
Black 4

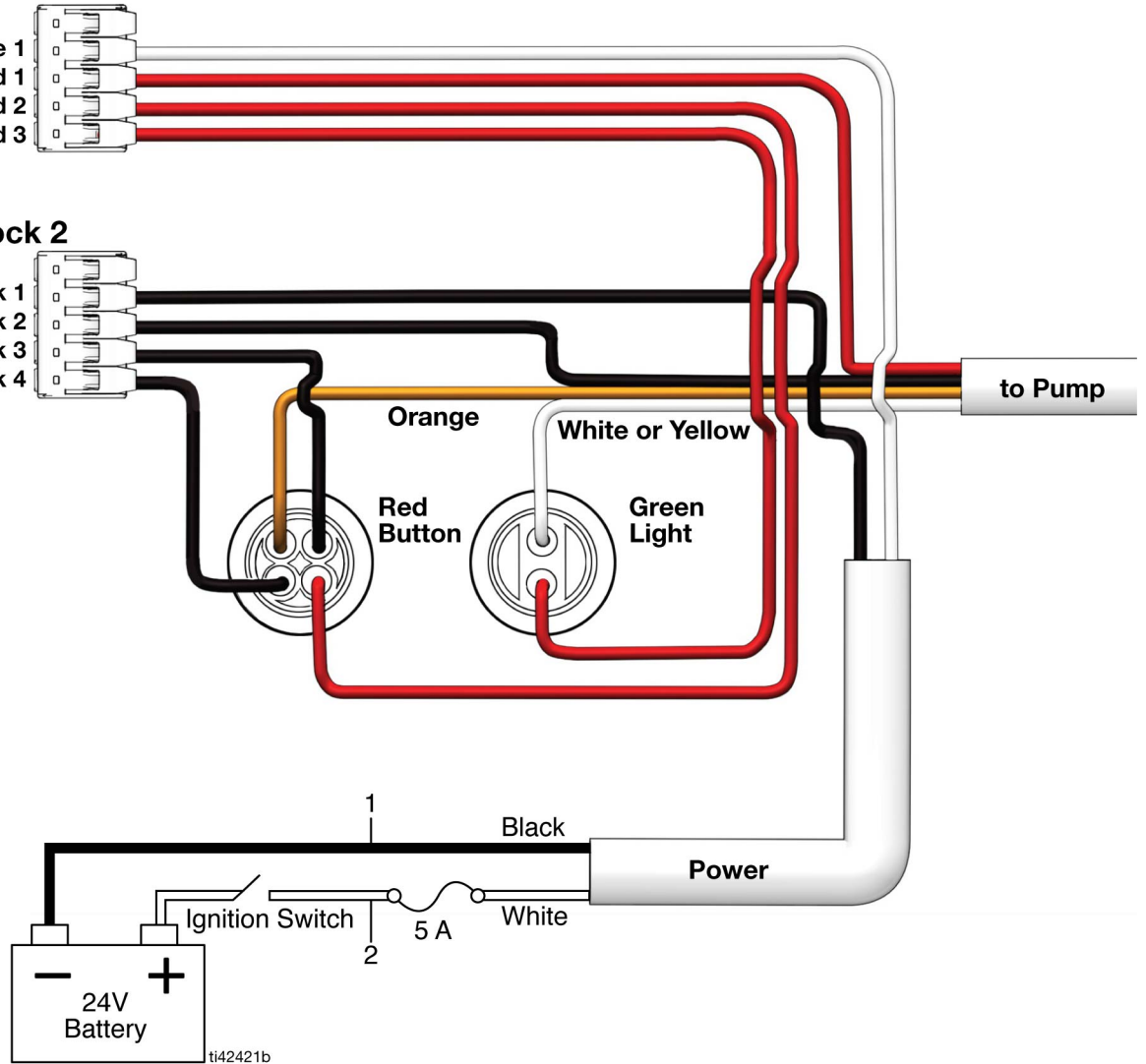

Parts

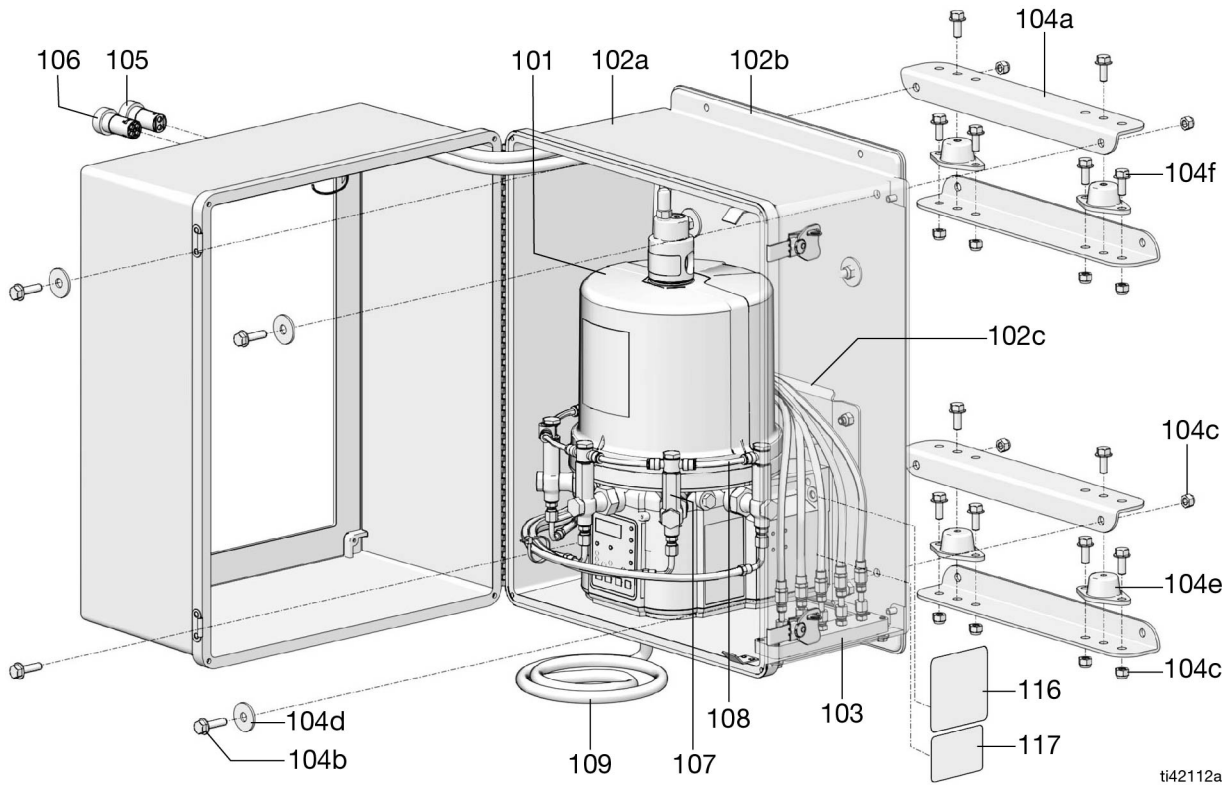

ti42112a

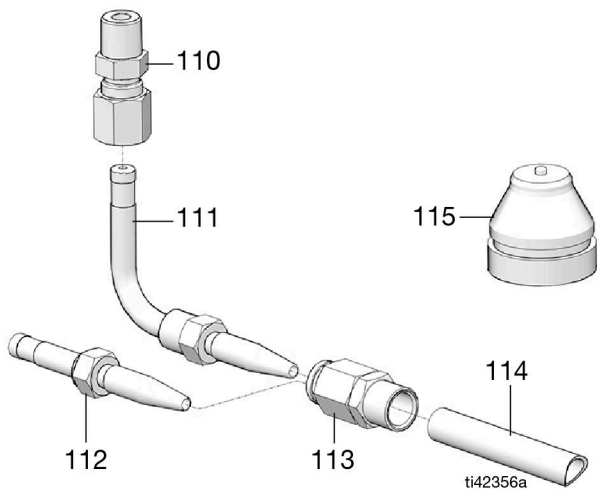

ti42356a

Part No./Description

Ref.	Part	Description	Model			
			134010	134011	134410	134411
101	95G102	Pump,G5-G-24NC-4L0000-C0000000	--	--	1	1
101	95G105	Pump,G5-G-24NC-4L0000-C0000000	1	--	--	--
101	95G108	Pump,G5-G-24NC-4L0000-C0000000	--	1	--	--
101a	127780 or 2003467	Cable, power, 15 ft, 5 wire, CPC (not shown)	1	1	1	1
102a†❖		Enclosure	1	1	1	1
102b†❖		Panel, back structure	1	1	1	1
102c†❖		Panel, rear mounting	1	1	1	1
103	134142	Manifold, Box Pump G5	1	--	1	1
103	134167	Manifold, Box Pump G5 w/ AFSSO	--	1	--	--
104	132163	Isolator, Kit 4 pack	1	1	1	1
104a		Bracket, Isolator, mounting	4	4	4	4
104b		Bolt, flange HD, serrated, M8X30	4	4	4	4
104c		Nut, lock	16	16	16	16
104d		Washer, fender	3	3	3	3
104e		Isolator, vibration, damping M8 THD	4	4	4	4
104f		Bolt, Flange HD, Serrated, M8X20	12	12	12	12
105	133994	Light, green, LED	1	1	--	--
106	133995	Button, red	1	1	--	--
107	133910	Valve, Pressure Relief 4000 PSI	5	5	5	5
108	133960	Kit, 5X, return to reservoir	1	1	--	1
109	134161	Cable, power/ground 10 ft	1	1	--	--
110	17T780	Fitting, compression	10	10	10	10
111	17R566	Stud, elbow, 6 mm, comp.	5	5	5	5
112	17R565	Stud, straight, 6 mm, comp.	5	5	5	5
113	17L648	Sleeve, hose	10	10	10	10
114	134171	Hose,8.6 mm, 25 m	1	1	1	1
115†❖	132095	Grommet, panel mount	1	3	3	3
116▲	16A579	Label, safety	1	1	1	1
117		Label, product	1	1	1	1

▲ Replacement safety labels, tags, and cards are available at no cost.

†Included in Small Enclosure Kit 134169

❖Included in Large Enclosure Kit 134170

Kits

Ref	Part
134169	Small Enclosure Kit
134170	Large Enclosure Kit

Dimensions

G5 in a Box

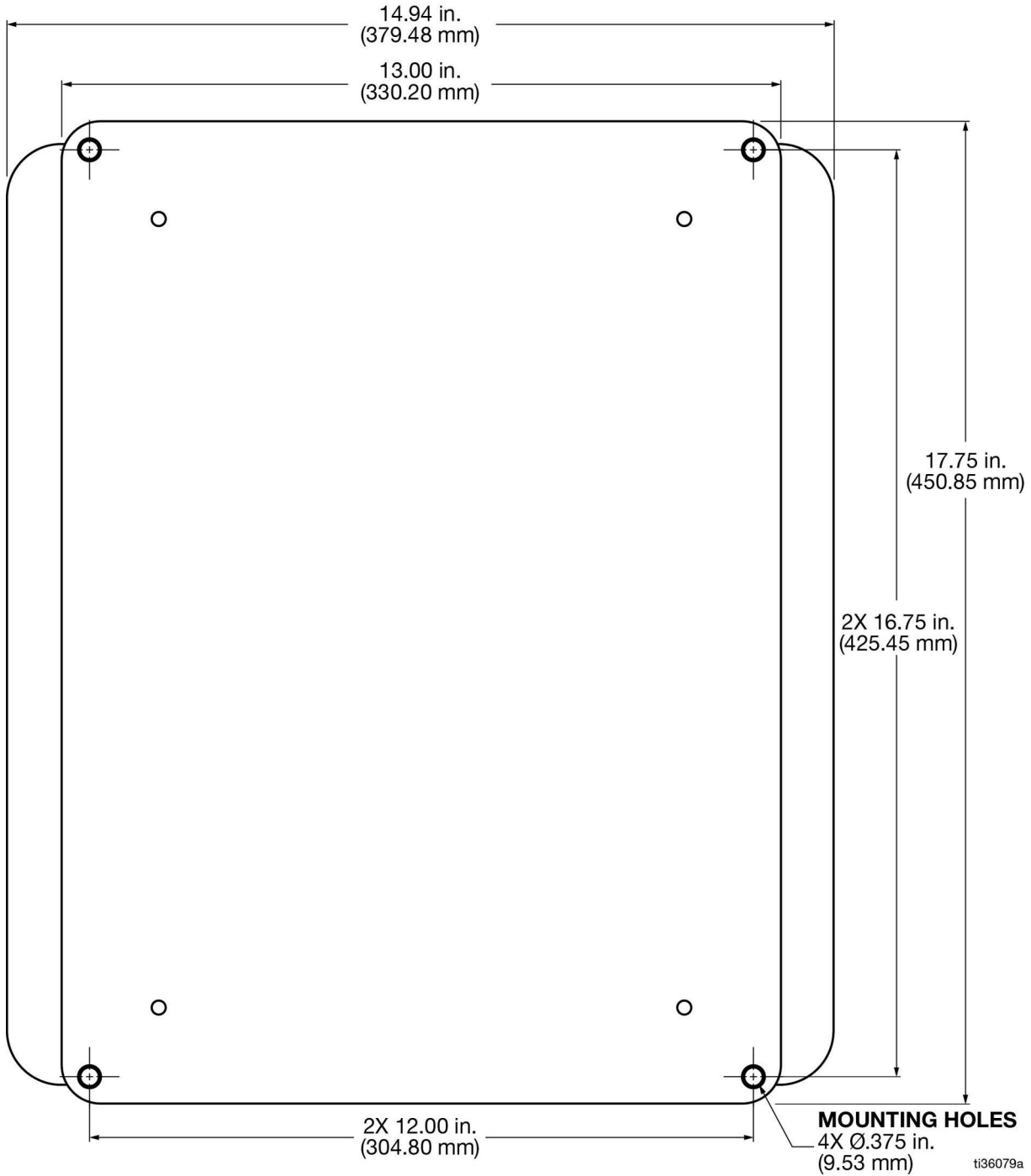

G5 in a Box with AFSO

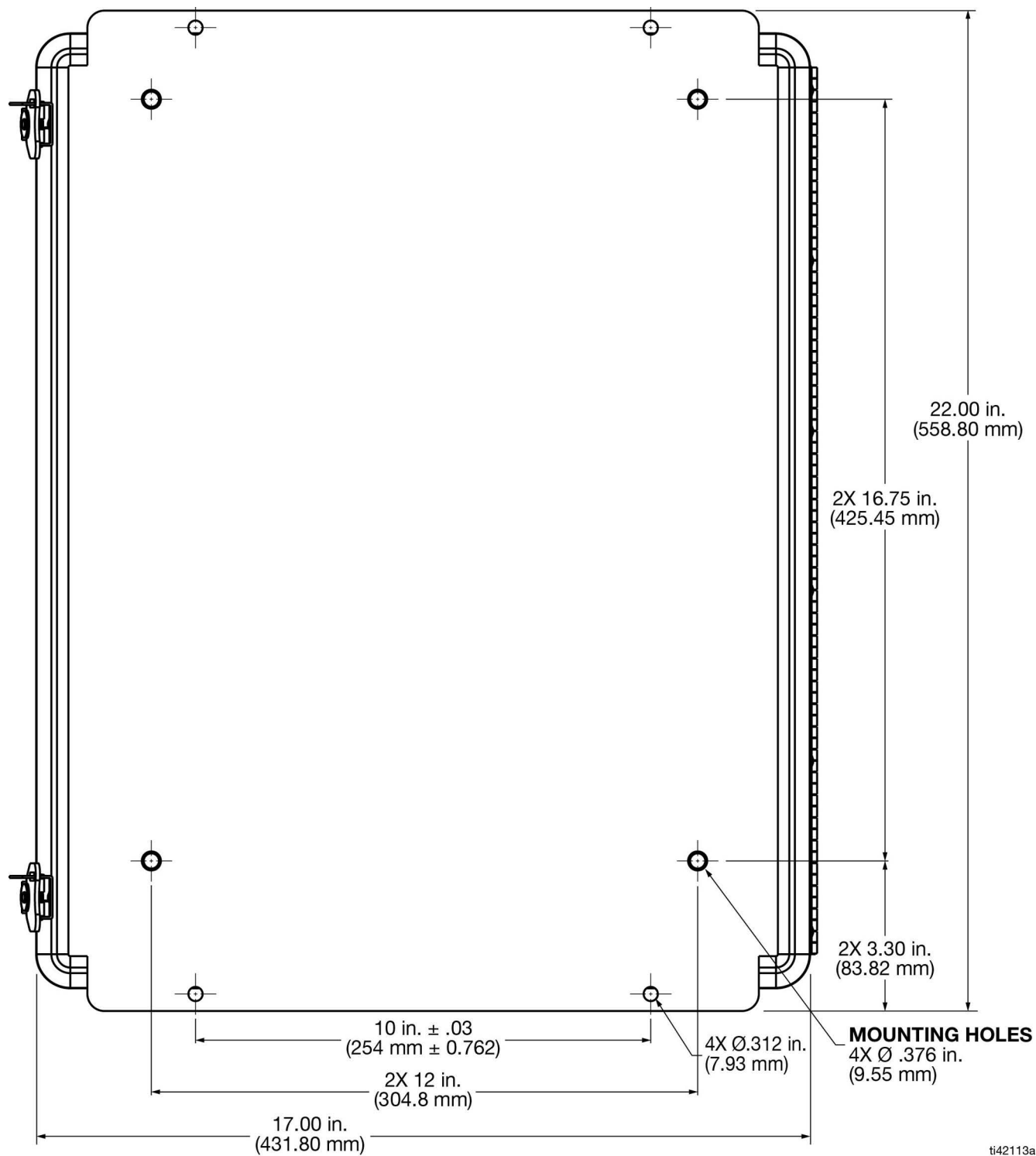

ti42113a

Technical Specifications

G5 In A Box		
Pump output pressure	3000 psi	20.7 MPa, 207 bar
Power		
24 VDC	18 - 32 VDC; 2.5 A current, 60 W, inrush/locked rotor 6 A	
Fluid		
Grease	Grease NLGI 000 - #2	
Oil	At least 40 cSt oil	
Pump Output	0.055 in. ³ /min (0.90 cm ³ /min) per outlet - 2 spacers	
	0.104 in. ³ /min (1.70 cm ³ /min) per outlet - 1 spacers	
	0.155 in. ³ /min (2.54 cm ³ /min) per outlet - 0 spacers	
Outlet	1/8 - 28 NPTF	
Reservoir Size	4 Liters	
IP Rating	IP69K	
Ambient Temperatures	-40°F to 158°F (-40°C to 70°C)	
Weight (Dry - includes power cord)		
3X System without AFSSO	47 lb	21.3 kg
5X System with AFSSO	72 lb	32.7 kg
Wetted Parts	Nylon 6/6 (PA), zinc plated steel, carbon steel, alloy steel, stainless steel, nitrile rubber (buna-N), bronze, nickel plated alnico, chemically lubricated acetal, aluminum, PTFE amorphous polyamide	
Sound Data	<60 dB	

All trademarks or registered trademarks are the property of their respective owners.

California Proposition 65

CALIFORNIA RESIDENTS

 **WARNING:** Cancer and reproductive harm – www.P65warnings.ca.gov.

Graco Standard Warranty

Graco warrants all equipment referenced in this document which is manufactured by Graco and bearing its name to be free from defects in material and workmanship on the date of sale to the original purchaser for use. With the exception of any special, extended, or limited warranty published by Graco, Graco will, for a period of twelve months from the date of sale, repair or replace any part of the equipment determined by Graco to be defective. This warranty applies only when the equipment is installed, operated and maintained in accordance with Graco's written recommendations.

This warranty does not cover, and Graco shall not be liable for general wear and tear, or any malfunction, damage or wear caused by faulty installation, misapplication, abrasion, corrosion, inadequate or improper maintenance, negligence, accident, tampering, or substitution of non-Graco component parts. Nor shall Graco be liable for malfunction, damage or wear caused by the incompatibility of Graco equipment with structures, accessories, equipment or materials not supplied by Graco, or the improper design, manufacture, installation, operation or maintenance of structures, accessories, equipment or materials not supplied by Graco.

This warranty is conditioned upon the prepaid return of the equipment claimed to be defective to an authorized Graco distributor for verification of the claimed defect. If the claimed defect is verified, Graco will repair or replace free of charge any defective parts. The equipment will be returned to the original purchaser transportation prepaid. If inspection of the equipment does not disclose any defect in material or workmanship, repairs will be made at a reasonable charge, which charges may include the costs of parts, labor, and transportation.

THIS WARRANTY IS EXCLUSIVE, AND IS IN LIEU OF ANY OTHER WARRANTIES, EXPRESS OR IMPLIED, INCLUDING BUT NOT LIMITED TO WARRANTY OF MERCHANTABILITY OR WARRANTY OF FITNESS FOR A PARTICULAR PURPOSE.

Graco's sole obligation and buyer's sole remedy for any breach of warranty shall be as set forth above. The buyer agrees that no other remedy (including, but not limited to, incidental or consequential damages for lost profits, lost sales, injury to person or property, or any other incidental or consequential loss) shall be available. Any action for breach of warranty must be brought within two (2) years of the date of sale.

GRACO MAKES NO WARRANTY, AND DISCLAIMS ALL IMPLIED WARRANTIES OF MERCHANTABILITY AND FITNESS FOR A PARTICULAR PURPOSE, IN CONNECTION WITH ACCESSORIES, EQUIPMENT, MATERIALS OR COMPONENTS SOLD BUT NOT MANUFACTURED BY GRACO. These items sold, but not manufactured by Graco (such as electric motors, switches, hose, etc.), are subject to the warranty, if any, of their manufacturer. Graco will provide purchaser with reasonable assistance in making any claim for breach of these warranties.

In no event will Graco be liable for indirect, incidental, special or consequential damages resulting from Graco supplying equipment hereunder, or the furnishing, performance, or use of any products or other goods sold hereto, whether due to a breach of contract, breach of warranty, the negligence of Graco, or otherwise.

FOR GRACO CANADA CUSTOMERS

The Parties acknowledge that they have required that the present document, as well as all documents, notices and legal proceedings entered into, given or instituted pursuant hereto or relating directly or indirectly hereto, be drawn up in English. Les parties reconnaissent avoir convenu que la rédaction du présente document sera en Anglais, ainsi que tous documents, avis et procédures judiciaires exécutés, donnés ou intentés, à la suite de ou en rapport, directement ou indirectement, avec les procédures concernées.

Graco Information

For the latest information about Graco products, visit www.graco.com.

For patent information, see www.graco.com/patents.

TO PLACE AN ORDER, contact your Graco distributor or call to identify the nearest distributor.

Phone: 612-623-6928 **or Toll Free:** 1-800-533-9655, **Fax:** 612-378-3590

All written and visual data contained in this document reflects the latest product information available at the time of publication. Graco reserves the right to make changes at any time without notice.

Original instructions. This manual contains English. MM 3A9275

Graco Headquarters: Minneapolis

International Offices: Belgium, China, Japan, Korea

GRACO INC. AND SUBSIDIARIES • P.O. BOX 1441 • MINNEAPOLIS MN 55440-1441 • USA
Copyright 2023, Graco Inc. All Graco manufacturing locations are registered to ISO 9001.

www.graco.com
Revision D, May 2024