

Prime/Spray Valve Replacement Kit for Hand-Held Sprayers

3A2777A

EN



Important Safety Instructions

For complete warnings and safety instructions, see sprayer manual.

Prime/Spray Valve Handle Replacement Kit 262601

Adjustable Prime/Spray Valve Replacement Kit 16M873

Fixed Prime/Spray Valve Replacement Kit 16M872

Fine Finish Adjustable Prime/Spray Valve Replacement Kits 16H119 & 16H461

Prime/Spray Valve Handle Kit 262601

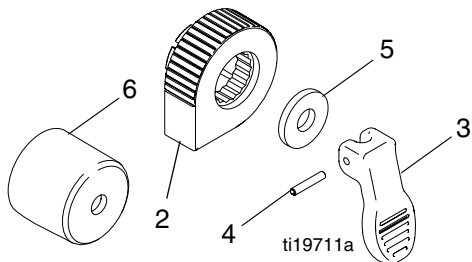

Adjustable Prime/Spray Valve Kit 16M873

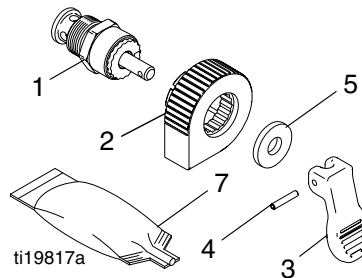

Fixed Prime/Spray Valve Kit 16M872

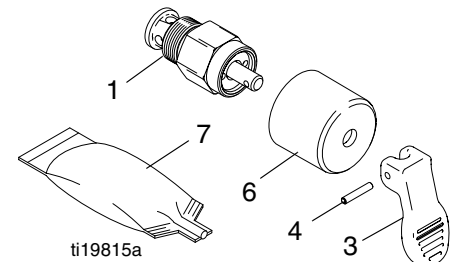

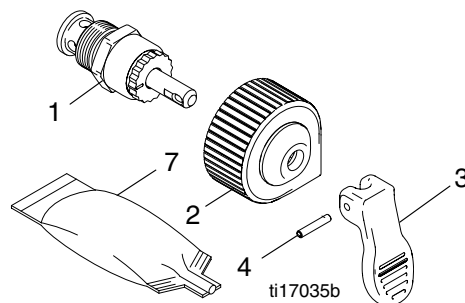

Fine Finish Adjustable Prime/Spray Valve Kit 16H119 & 16H461



Ref.	Description	Qty.
1	VALVE, assy, prime,	1
2	KNOB, pressure adjust	1
3	HANDLE, drain valve	1
4	PIN, straight	1
5	WASHER, plain	1
6	CAP	1
7	SEALANT, pipe, sst	1

Adjustable Pressure Sprayers

Pressure Relief Procedure

			
<p>Do not operate or spray near children. Do not aim the sprayer at, or spray any person or animal. Keep hands and other body parts away from the front of the sprayer. For example, do not try to stop the paint flow with any part of the body.</p> <p>This sprayer builds up an internal pressure of 3,300 psi during use. Follow this Pressure Relief Procedure whenever you stop spraying and before cleaning, checking, servicing, or transporting equipment to prevent serious injury.</p>			

1. Engage trigger lock.

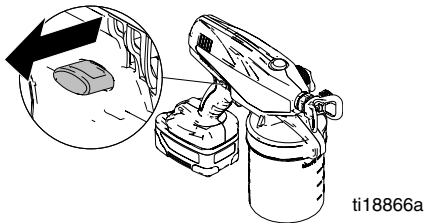

2. Put prime/relief valve UP to release pressure.

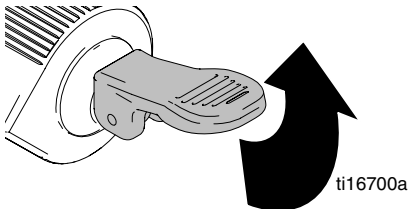

Removal

			
---	---	---	--

1. Perform **Pressure Relief Procedure**.
2. Turn pressure control knob fully clockwise.

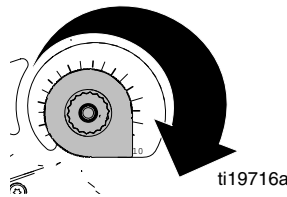

3. Remove pin (3) from prime valve handle (4).

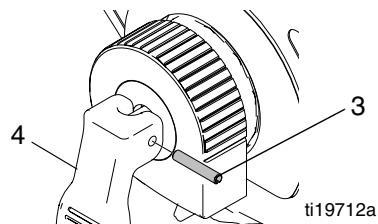

4. Remove valve handle (4).

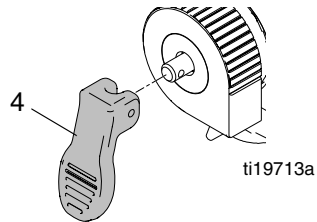

5. If applicable, remove control knob (2) and washer (5).

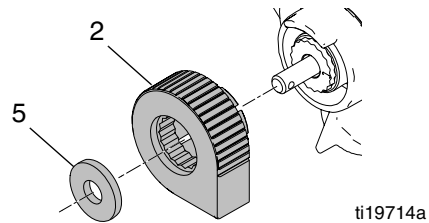

6. Use 13/16 in. deep socket to remove prime valve.

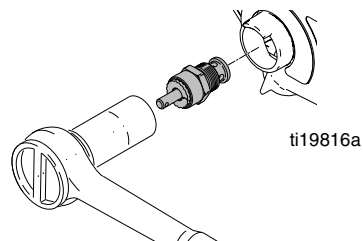

Installation

1. Apply pipe sealant to exterior threads of metal prime valve housing.

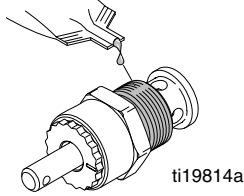

2. Use 13/16 in. deep socket to install valve into pump. Torque to 150 in-lb.

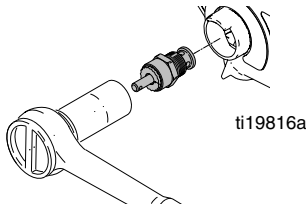

3. Make sure line on retainer face is aligned with the mark on the valve housing.

Kit 16M873: Valve retainer should protrude approximately .130 in. out from valve housing.

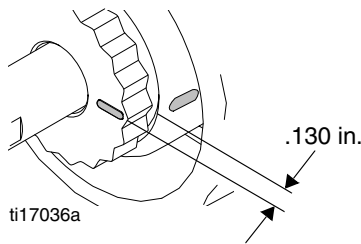

Kits 16H119 & 16H461: Valve retainer should protrude approximately .175 in. out from valve housing.

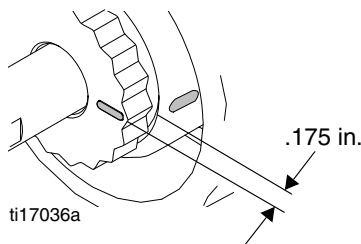

4. If your sprayer has a removable stop sleeve, make sure it is installed into the sprayer.

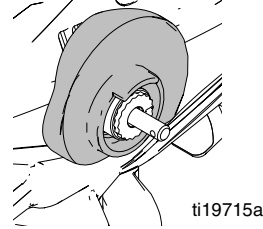

5. Position knob (2) in fully clockwise position and press onto valve.

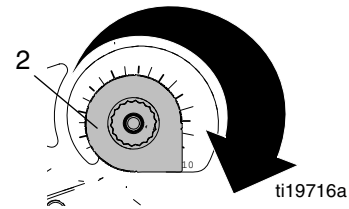

6. If applicable, install washer (5) onto knob (2).

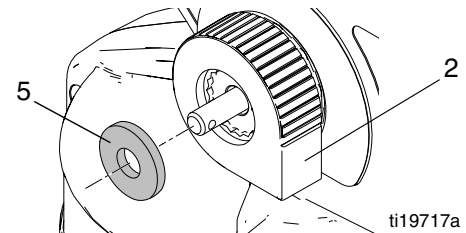

7. Install valve handle (4) onto stem.

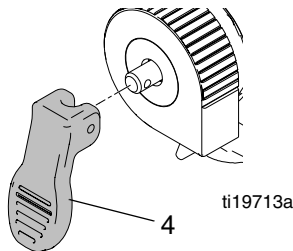

8. Insert pin (3) into valve handle (4). Use pliers to press pin into hole.

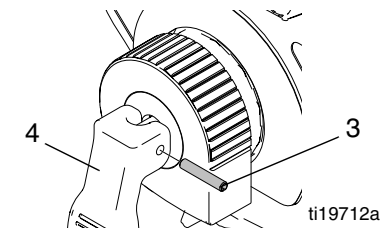

Fixed Pressure Sprayers

Pressure Relief Procedure

<p>Do not operate or spray near children. Do not aim the sprayer at, or spray any person or animal. Keep hands and other body parts away from the front of the sprayer. For example, do not try to stop the paint flow with any part of the body.</p> <p>This sprayer builds up an internal pressure of 3,300 psi during use. Follow this Pressure Relief Procedure whenever you stop spraying and before cleaning, checking, servicing, or transporting equipment to prevent serious injury.</p>			

- Engage trigger lock.

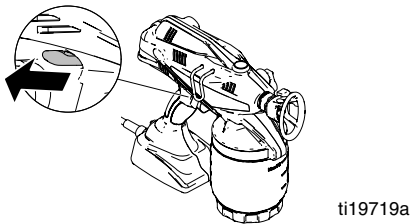

- Put prime/relief valve UP to release pressure.

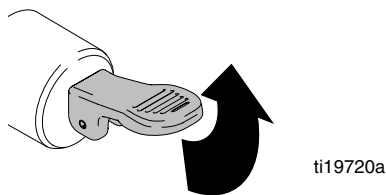

Removal

--	--	--	--

- Perform **Pressure Relief Procedure**.
- Remove pin (3) from prime valve handle (4).

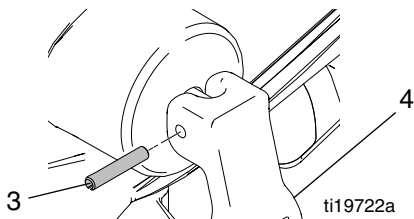

- Remove valve handle (4).

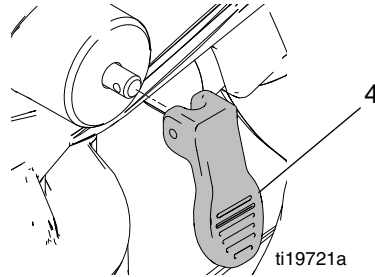

Installation

- Install cap (1) into sprayer.

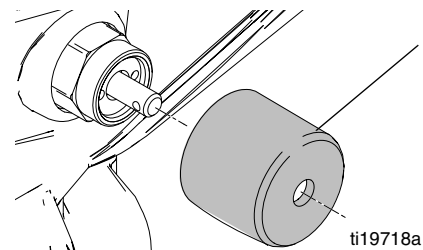

- Install valve handle (4) onto stem.

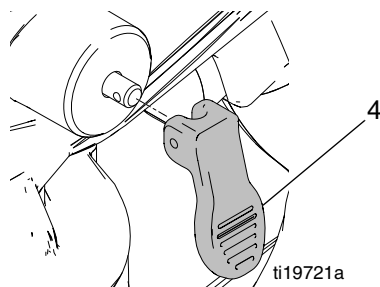

- Insert pin (3) into valve handle (4). Use pliers to press pin into hole.

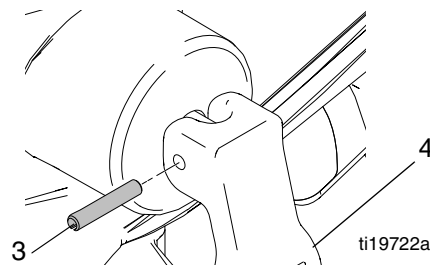

*All written and visual data contained in this document reflects the latest product information available at the time of publication.
Graco reserves the right to make changes at any time without notice.*

For patent information, see www.graco.com/patents.

Original instructions. This manual contains English. MM 3A2777

Graco Headquarters: Minneapolis

International Offices: Belgium, China, Japan, Korea

GRACO INC. AND SUBSIDIARIES • P.O. BOX 1441 • MINNEAPOLIS MN 55440-1441 • USA

Copyright 2012, Graco Inc. All Graco manufacturing locations are registered to ISO 9001.

www.graco.com

Revision A - August 2012