

INSTRUCTIONS - PARTS LIST

This manual contains **IMPORTANT WARNINGS** and **INSTRUCTIONS**
READ AND RETAIN FOR REFERENCE



306-999

OCT. 1971

Supersedes SEPT. 1970

E-M 350

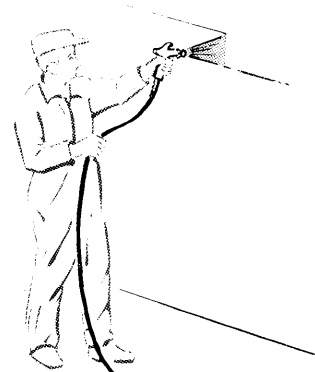

U. S. Patent 3,614,352

ELECTRIC "AIRLESS" PAINT SPRAYER

Model 226-350 Series "C"

Model 208-035 Series "B"

Same as 226-350, less gun, spray tip and swivel

Model 226-361 Series "B"

Same as 226-350, except has 50 Hz motor

Model 226-365 Series "B"



CANADIAN
STANDARDS
ASSOCIATION
APPROVED

otherwise same as 226-350

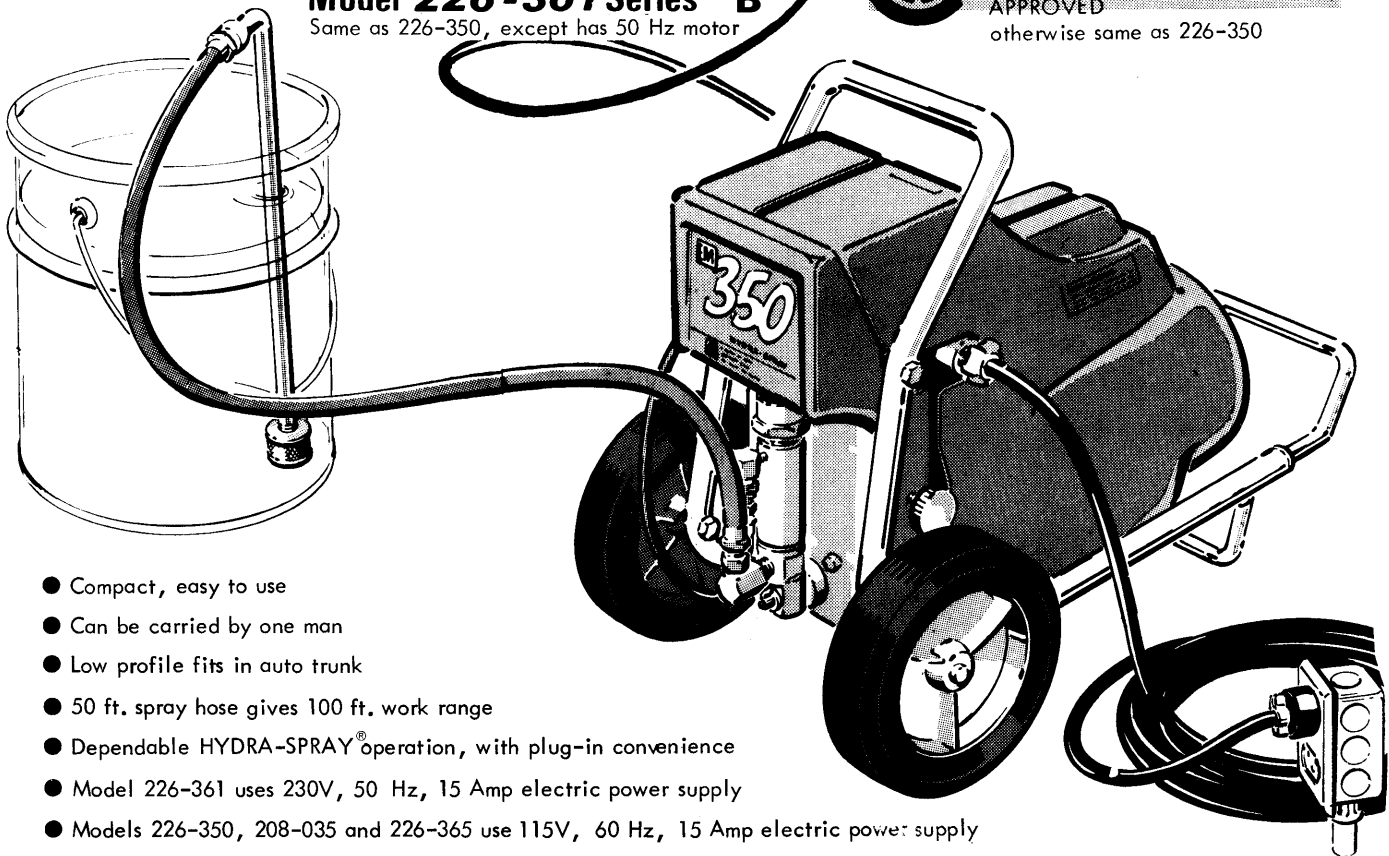

- Compact, easy to use
- Can be carried by one man
- Low profile fits in auto trunk
- 50 ft. spray hose gives 100 ft. work range
- Dependable HYDRA-SPRAY® operation, with plug-in convenience
- Model 226-361 uses 230V, 50 Hz, 15 Amp electric power supply
- Models 226-350, 208-035 and 226-365 use 115V, 60 Hz, 15 Amp electric power supply
- 1/3 gpm continuous delivery supports non-stop operation of 1 gun with up to .019 spray tip

■ Capacitor-start electric motor is fan cooled and has thermal overload protection with automatic reset ■ Motor is explosion-proof and has explosion-proof On-Off switch ■ External pressure adjustment ■ Hydra-Spray paint pump is divorced design ■ Pump has wet-cup packing lubricator, replaceable nitralloy displacement rod, nitralloy body and hardened steel ball check valves ■ Has a high pressure paint filter ■ TECHNICAL DATA on back page, ACCESSORIES on page 11.

IMPORTANT **READ and UNDERSTAND**

SAFETY PRECAUTIONS

KEEP CLEAR of moving parts when unit is running; do not put your fingers into any openings in shroud.

ALWAYS CHECK to be sure switch is OFF and all lines are clear of moving parts, before plugging in the power cord.

ALWAYS unplug unit before removing shroud for any reason.

High fluid pressure remains in the system until you relieve it by shutting off the electricity to pump and releasing the fluid pressure through the opened spray gun. If the fine high pressure stream of paint released from spray gun comes in direct contact with the hand or any part of human body it can penetrate the skin and cause physical harm. The high velocity flow of material through the spray tip may develop static electricity. If static sparking occurs, fire or explosion could result. Because of these facts, anyone using this equipment must take the following precautions.

DO NOT use solvent under pressure to clear obstructed tip. If static sparking occurs, vapors may ignite and cause a fire or explosion. Remove tip from gun and clean. Use bare metal waste containers only.

GROUND UNIT and the object you are going to spray to prevent static sparking. Unit is grounded to plug -- be sure electric supply circuit is grounded. BE SURE the extension cord, if used, has 3 wires of 12 gauge (min).

Handle gun with care! High pressure (up to 3000 PSI) at gun nozzle can cause serious injury. THIS IS NOT AN AIR SPRAY UNIT, DO NOT try to "blow-back" fluid.

Keep gun trigger safety ON when not spraying.

ALWAYS turn unit off and squeeze gun trigger to relieve pressure when through spraying and before removing spray tip or servicing unit.

CAUTION

See page 11 for recommended lubricant. Gearcase holds 3 pints. DO NOT use hypoid grease. Use at least 50 ft of hose. DO NOT use metal braid hose.

OPERATION

BEFORE YOU PLUG IN the power cord to electric outlet, do the following:

CHECK GEARCASE LUBE

Remove fill plug and check level of gearcase lube. See Fig 1. Lube level should be up to plug.

CONNECT GUN

Screw hose swivel onto outlet manifold-filter's $\frac{1}{4}$ NPSM nipple, then gun swivel end of hose onto gun's inlet connection. Do not use thread sealer.

LUBRICATE PRESSURE CONTROL PLUNGER

Place several drops of TSL on plunger to lubricate and prevent material build-up. See Fig 8.

PRESET PRESSURE CONTROL

Turn pressure control knob to lowest setting. See Fig 1.

CHECK ELECTRIC SERVICE and PLUG IN

For models 226-350, 208-035 and 226-365, electric service must be 115 V, 60 Hz AC, fused for 15 amp. For model 226-361, electric service must be 230 V, 50 Hz AC, fused for 15 amp. Before you plug in the cord, be sure the circuit is correct.

NOTE

If you have model 226-361, you must add plug to end of cord and remove cover from pressure control housing and connect wires according to local code. See Fig 8.

WARNING

Select a service outlet which will locate your unit at least 20 feet away from the spraying area. Be sure that the circuit is properly grounded. Model 226-365 is CSA approved for hazardous location, Class 1, Group D.

OPERATION (Continued)

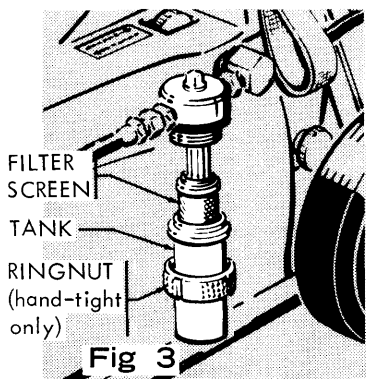
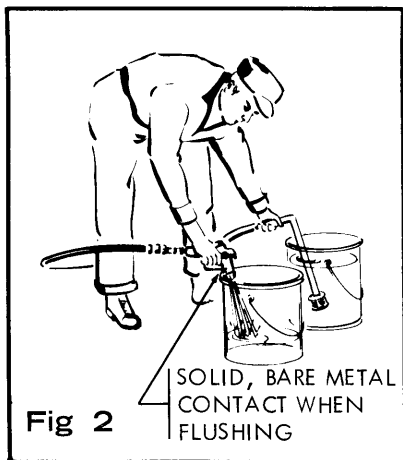
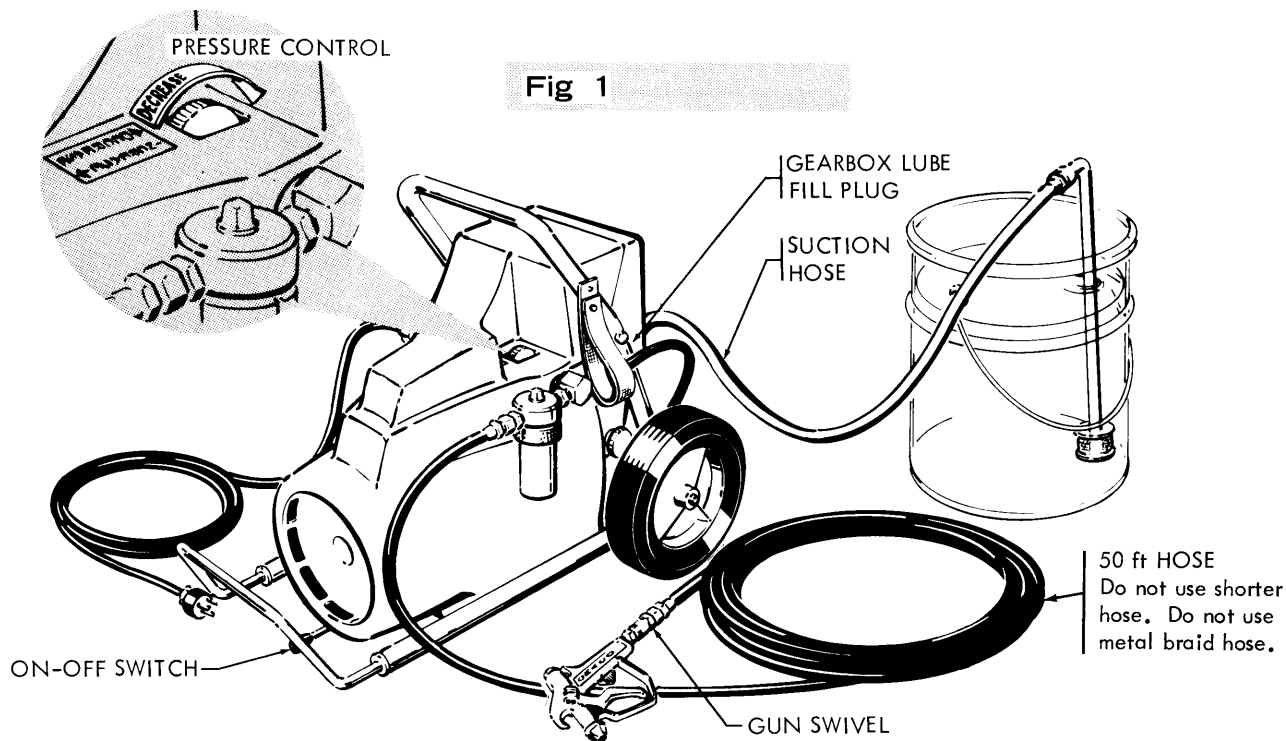

Fig 1

Check to be sure ON-OFF switch is in the OFF position (push in), then plug cord into service outlet. If you have to use an extension cord to reach a service outlet, be sure it is a 3-wire, 12 gauge minimum cord with safety grounding plug and socket (see accessory page 11.)

FLUSH OIL OUT OF PAINT PUMP

You will have to flush oil used for testing and protection out of the paint pump before starting to spray. To flush proceed as follows:

Pour about $\frac{1}{2}$ gallon of clean, mineral spirits into an empty, bare metal 5-gallon pail--take precautions to prevent static sparking when pouring solvent. Put suction tube into pail. Turn pressure control wheel to lowest setting, pull switch out to ON position--pump will prime with solvent and stop.

Hold spray gun nozzle firmly against metal waste container and squeeze trigger See Fig 2. Hold trigger fully open to obtain prime. Hold trigger back until clean solvent is spraying from nozzle, then release it.

Check all paint line fittings for leaks, and tighten if necessary. Be sure the pump's inlet fitting is tight.

Remove the suction tube from the solvent pail. Squeeze gun trigger to let pump force the solvent out of hose (30 seconds maximum), then push switch arm into the OFF position.

Pull the plug out of electrical outlet, squeeze gun trigger to relieve pressure, and unscrew the filter ring nut from the outlet manifold-filter. Remove the tank and check the screen to see that it is clean. Reassemble, hand tight only. See Fig 3.

OPERATION (Continued)

FILL WETCUP

Pour Graco Throat Seal Lubricant (TSL) supplied, into wet-cup until wet-cup is about 1/3 full. See Fig 4. Plug cord into service outlet.

MIX PAINT; ADJUST PRESSURE & SPRAY

WARNING

1. PREVENT STATIC SPARKING! Your unit is grounded to the powercord plug. Ground the object you are going to coat, if it is static generating, and be sure your electric supply circuit is grounded.
2. KEEP AWAY FROM HIGH PRESSURE SPRAY! DO NOT point the spray nozzle at yourself or any other person. High pressure spray can penetrate the skin and cause serious injury.
3. ALWAYS RELIEVE PRESSURE before disconnecting gun or removing tip -- turn unit off, pull plug from outlet, and squeeze gun trigger.
4. ALWAYS put trigger safety ON when you stop spraying.

Prepare the paint as instructed by paint manufacturer. Paint should be free of undissolved skin, dirt or any foreign material.

Put the paint suction tube into the pail of paint. Do not install spray tip yet. Squeeze gun trigger, turn unit on, and let run until all the air is forced out of the system.

NOTE

If paint is extremely viscous and difficult to prime, first remove strainer from suction tube, then prime unit with water or a compatible solvent. When primed, turn the unit OFF, plug the immersed end of suction tube with one finger, and transfer it to the pail of viscous material. This prevents air being sucked in and loss of unit's priming power. Replace strainer.

Install spray tip in gun. Adjust spray pressure to the lowest pressure needed for satisfactory operation, spray a test area to check spray pattern. The tip size and angle determines the pattern width and flow rate. Don't try to get more coverage by increasing the pressure -- use a larger tip. Separate spray gun literature will tell you the right way to apply paint by "airless" spraying.

SHUTDOWN & CARE OF YOUR UNIT

WARNING

Proper shutdown procedure is important. You must follow these steps: turn off switch, unplug cord from electrical outlet, trigger the gun to relieve pressure, put gun trigger safety on. For safety's sake make it a habit to always shutdown properly before doing any maintenance such as cleaning the spray tip or adjusting packing nut, and before leaving the machine unattended. When the pump stalls out and the motor shuts off, there is no indication that the machine is "alive" and under pressure. You must shut off the switch and trigger the gun, to relieve pressure.

Remove and clean tip as necessary when spraying and always stop pump at the bottom of its stroke when through. Check packing nut periodically and tighten only as necessary. Overtightening may cause binding and excessive packing wear.

Clean tip, tip filter and outlet manifold filter often, and when storing unit. Flush all paint out of unit, as instructed on page 3, on the last workday of each week. If you are spraying paint that dries out more quickly than overnight, flush daily at shutdown. If you use water to flush, pump it out and fill with mineral spirits solvent.

CAUTION

TO PREVENT STALLING AND POSSIBLE DAMAGE TO GEAR TRAIN, be sure water, if used for flushing, is not left in pump to freeze in cold weather.

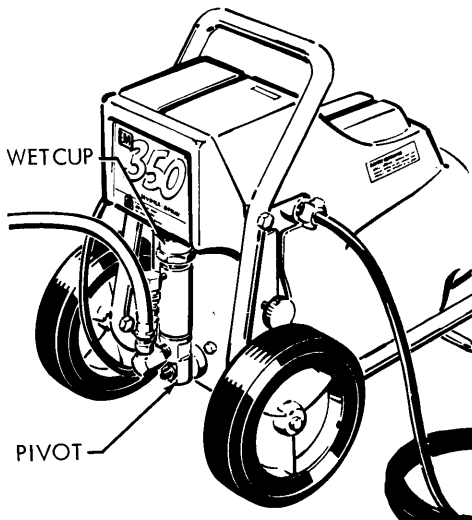

Fig 4

OPERATION (Continued)

NOTE

If pump fails to stall out with solvent in it, intake valve ball check may be obstructed. Remove, clean as instructed on page 6 and reassemble while parts are wet. Then complete flushing.

After stopping unit always trigger gun open to relieve pressure. Remove tip from gun and element from filter and clean them. Refer to attached manuals for instructions. Leave tip in clean mineral spirits solvent until next use. Leave unit filled with mineral spirits solvent until ready to use again. Leave hose connected to gun and immerse gun nozzle in solvent -- nozzle only.

Each morning, before starting unit, squirt one drop of oil onto the lower pivot point of the pump. See Fig 4.

Periodically, or if electric motor is overheating, unplug unit, remove shroud and clean all paint, dirt, dust, etc., off the shroud, and motor. Change gearcase lube once a year, more often if conditions warrant. Gearcase holds 3 pt.

SERVICE

TROUBLE SHOOTING CHART

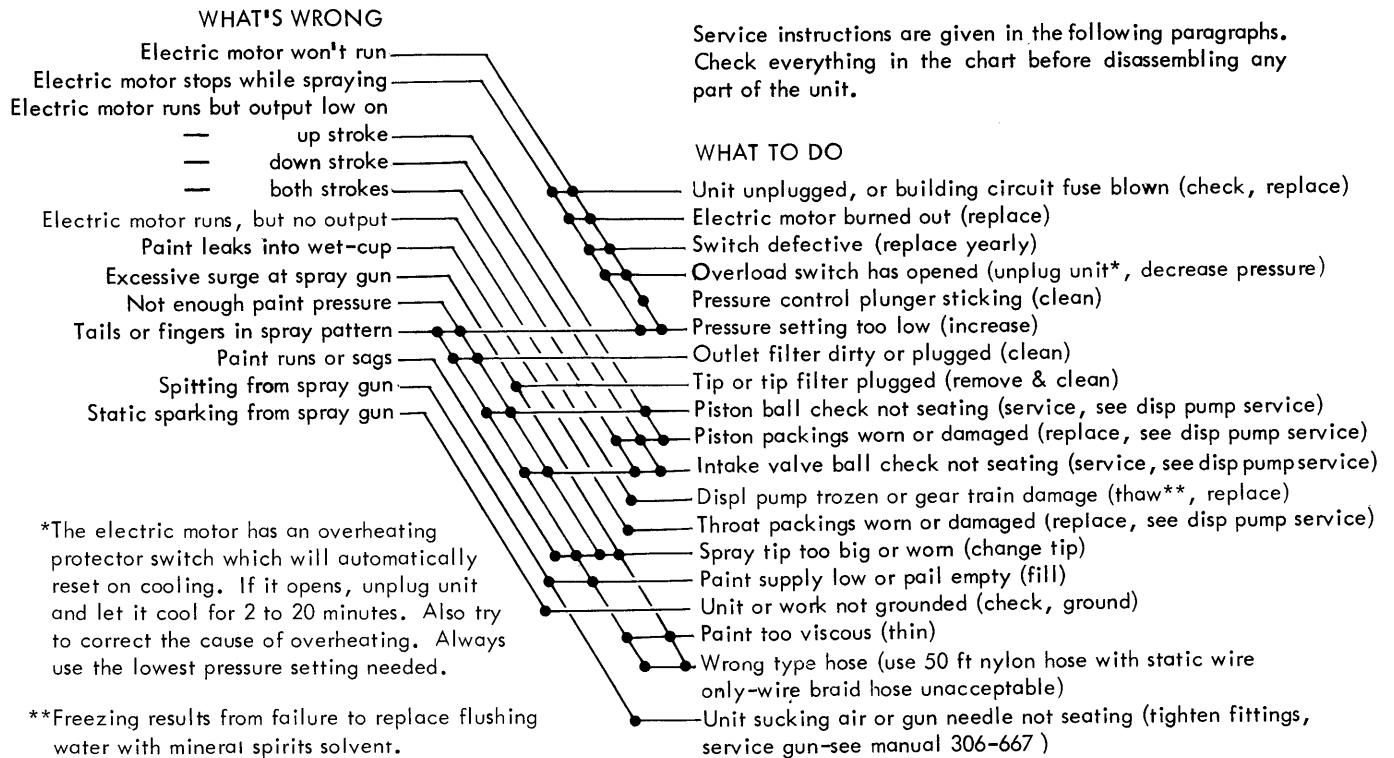

*The electric motor has an overheating protector switch which will automatically reset on cooling. If it opens, unplug unit and let it cool for 2 to 20 minutes. Also try to correct the cause of overheating. Always use the lowest pressure setting needed.

**Freezing results from failure to replace flushing water with mineral spirits solvent.

HOSE REPAIR

See manual 306-997 for hose repair instructions. A damaged or improperly repaired hose could be highly dangerous.

After repairing the hose, check it for ground wire contact as shown. The bulb must light. If it doesn't, remove coupling and check ground wire and contact surface of coupling. Hose must make a complete circuit before it can be used. See Fig 5.

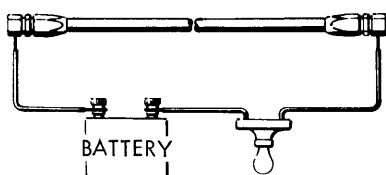

Fig 5

SERVICE (Continued)

NOTE

Do not raise hood higher than shown.

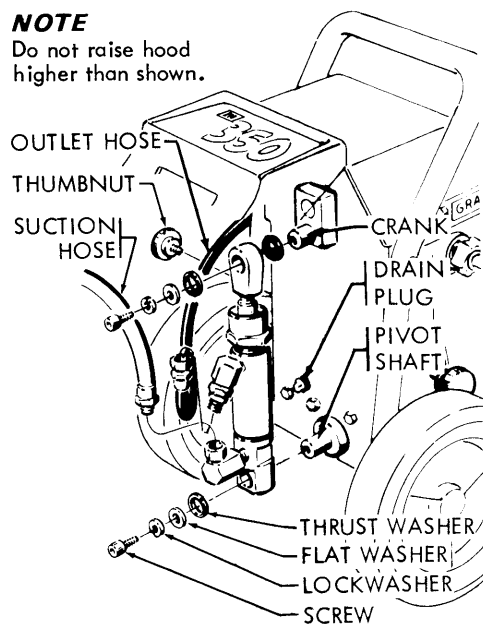

Fig 6

SERVICING DISPLACEMENT PUMP

(Repair Kit 208-031 available)

BEFORE DISASSEMBLING

Flush, if possible. Shut off unit, remove plug from electrical outlet, squeeze gun trigger to release pressure. Loosen thumbnuts, raise front hood of shroud. Use repair kit no. 208-031 to repair pump. Use all parts in kit, even if old ones look good.

REMOVE PUMP

You must remove pump, for service. Disconnect suction hose and outlet hose. Remove hex socket head capscrews, lockwashers, flat washers, and thrust washers from pivot shaft and crank. Be very careful to hold pump straight as you slide it off the shafts. See Fig 6.

INTAKE VALVE

Screw elbow out of intake valve housing. Screw intake valve housing out of displacement cylinder. Remove ball stop pin, ball guide and ball. Clean and inspect. Reassemble, using new parts in repair kit. See Fig 7.

NOTE

You can test valve by filling it with solvent and seeing if any leaks past ball. It should hold without leakage. Valve must be clean for this test, as dirt particles can hold ball off seat, letting solvent leak past.

THROAT PACKINGS; DISPLACEMENT ROD AND PISTON

Screw packing nut out of pump throat. Carefully pull displacement rod and piston out through pump throat. Wrap the rod end with tape to protect the bearing, and clamp securely in a vise. Screw piston off rod using a wrench on flats of piston. If piston is very tight, heat in boiling water to soften locking compound. Remove ball, glands and packings. Slide throat packings and glands off rod. Clean and inspect. Install repair kit parts. Be sure to install "Teflon" and leather packings in order shown. When assembling piston to rod, thoroughly clean and degrease, use locking compound on threads and torque to 225-250 in-lb. See Fig 7.

BEARINGS

Displacement pump bearings are replaceable. To remove, position rod end or intake valve housing properly in an arbor press, and press out bearing. Press in new bearing. See Fig 7. Soak bronze bearing in oil before installing. Grease displacement rod bearing whenever pump is removed.

SERVICING PRESSURE CONTROL

Shut off unit, remove plug from electrical outlet, trigger spray gun to release pressure. Loosen thumbnuts on sides of shroud, raise front hood and slip shroud back. Disconnect hoses from pressure control.

REPLACE MICROSWITCH

Remove switch housing cover. Replace switch. Switch should be replaced yearly. Connect wires as shown. Screw cover snugly onto housing. See Fig 8.

SERVICE ADJUSTING MECHANISM

Disconnect hoses from pressure control. Loosen setscrew, then screw out plunger guide. Remove o-ring and back-up ring. Clean thoroughly and inspect parts for wear or damage. The slightest nick or cut in the o-ring will lead to leakage. Scratches or burrs on the fluid sealing parts will lead to early failure of o-ring. Replace as necessary. Reassemble carefully. See Fig 8.

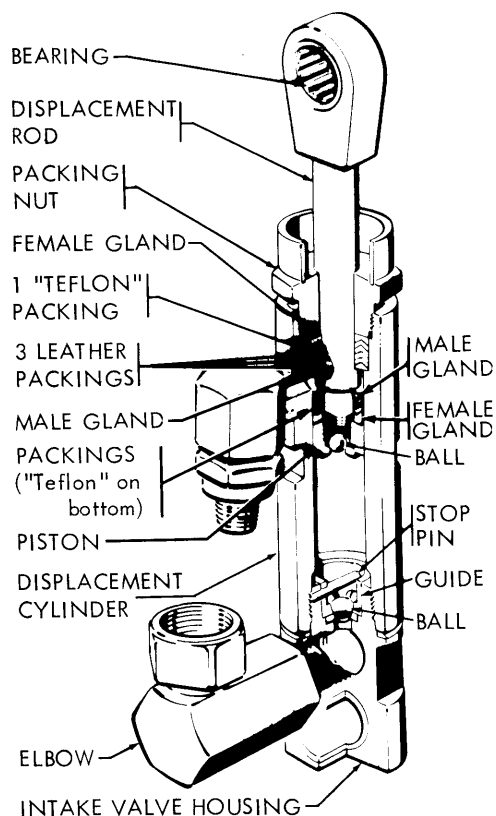

Fig 7

NOTE

If spring or plunger need replacement, order service replacement pressure control assembly number 207-899. Disconnect hoses, conduit and wires from pressure control. Remove pressure control from gearcase cover. Install new pressure control, connect wires, conduit and hoses. See Fig 9.

SERVICE (Continued)

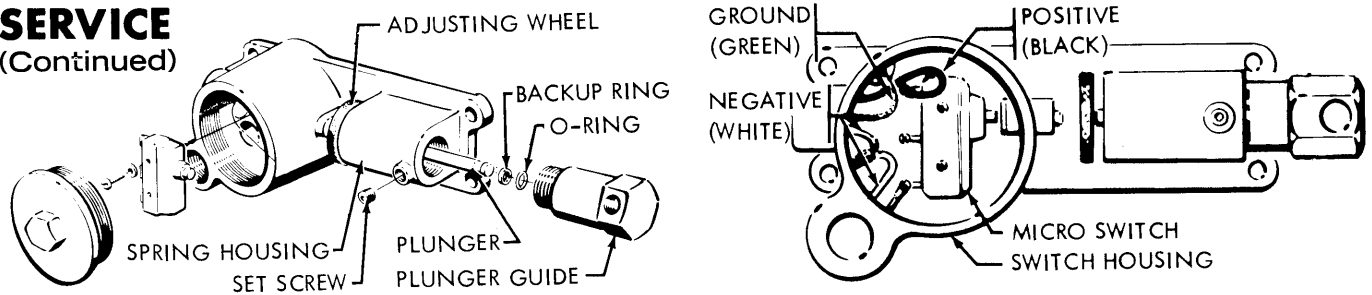

Fig 8

SERVICING MOTOR and GEAR TRAIN

TO REPLACE MOTOR

REMOVAL

Shut off unit, remove plug from electrical outlet, trigger spray gun to release pressure. Loosen thumbnuts on sides of shroud, raise front hood and slip shroud back. Disconnect hoses from displacement pump.

MODELS 226-350
208-035
226-361

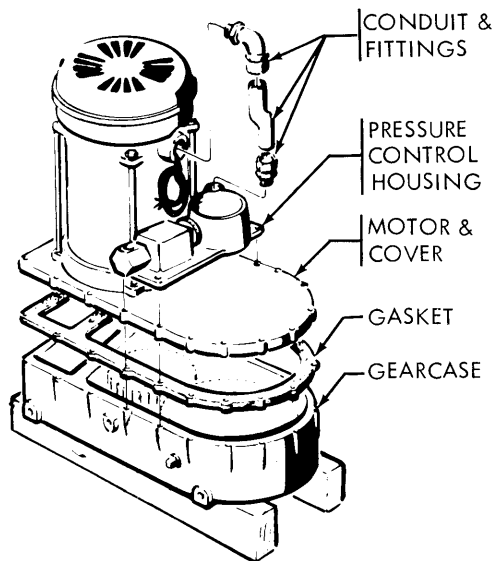

NOTE

Do not attempt to remove motor from gearcase cover. Service replacement motor includes cover. These are matched parts, and sold assembled only. For models 226-350, 208-035 and 226-365, order service replacement motor assembly number 207-960. For model 226-361, order service replacement motor assembly number 208-099. Either motor includes new gear and bearings installed in motor and cover, and new gasket.

Remove gearcase drain plug. See Fig 6. Disconnect conduit and wires from pressure control to motor. Remove pressure control from cover. Remove wheels from frame. Screw the 4 capscrews out of pump side of gearcase, below drain plug. See Fig 6. Screw out the 4 capscrews holding gearcase to frame. Remove motor and gearbox from frame and set up on 2 x 4's, as shown. Screw out the 18 gearcase cover capscrews. Carefully lift motor and cover straight up off gearcase. Discard old gasket. See Fig 9.

CAUTION

Loose gear cluster could stick in cover -- do not let it drop.

MODEL 226-365

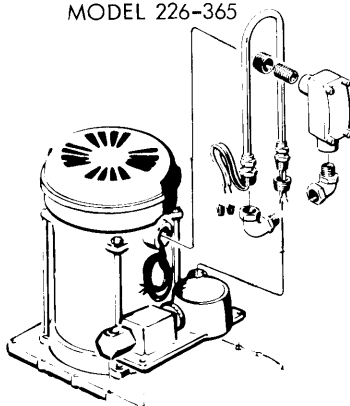

Fig 9

INSTALL NEW MOTOR

Position new gasket on gearcase - surface must be clean and free of nicks. Be sure gears and washers are in place, then carefully lower motor and cover into place, turning crank a little to help mesh the gears.

Continue reassembly by reversing disassembly procedure. Fill to proper level with proper type gearcase lube (the gearcase holds 3 pints).

TO INSTALL NEW GEAR TRAIN

For models 226-350, 208-035 and 226-365, order service replacement gear train assembly number 208-030. For model 226-361, order service replacement gear train assembly number 208-114. Follow the procedure given above for motor replacement; also remove displacement pump, but do not disconnect wires.

PARTS DRAWING

ELECTRIC "AIRLESS" PAINT SPRAYER

Model 226-350 Series "C"

Model 208-035 Series "B"

Same as 226-350, less gun, spray tip and swivel

Model 226-361 Series "B"

Same as 226-350, except has 50 Hz motor

Model 226-365 Series "B"

 otherwise same as 226-350

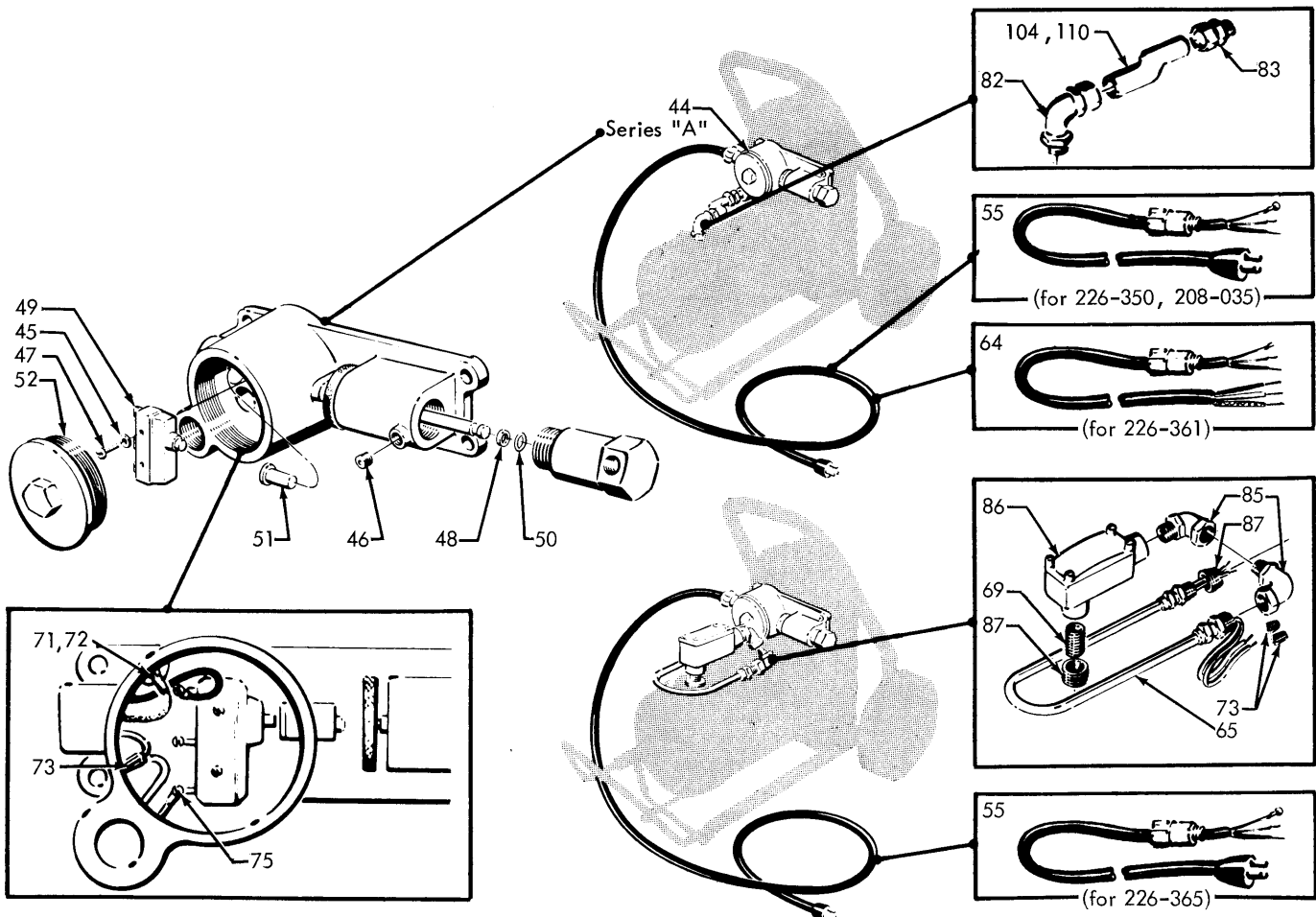
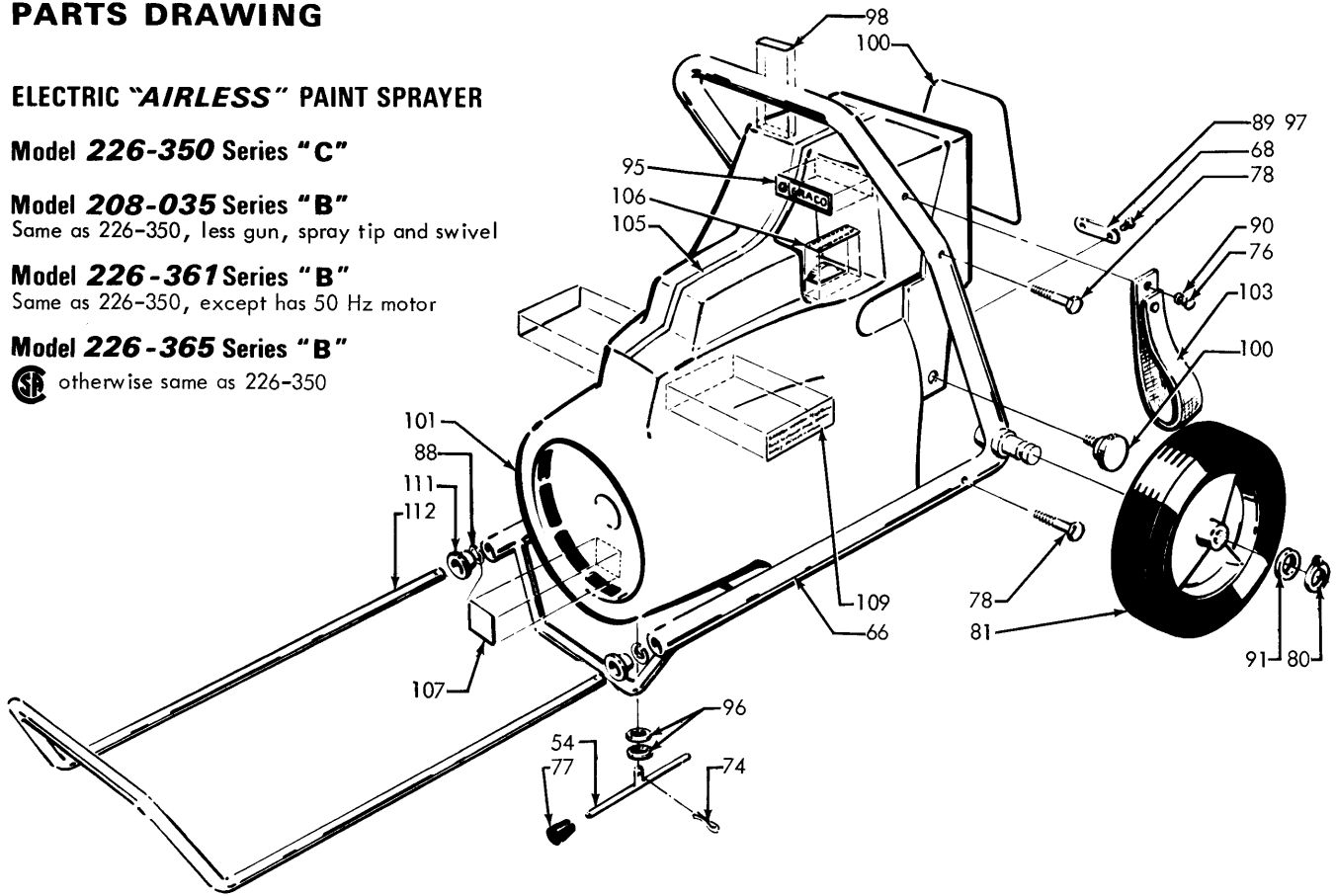

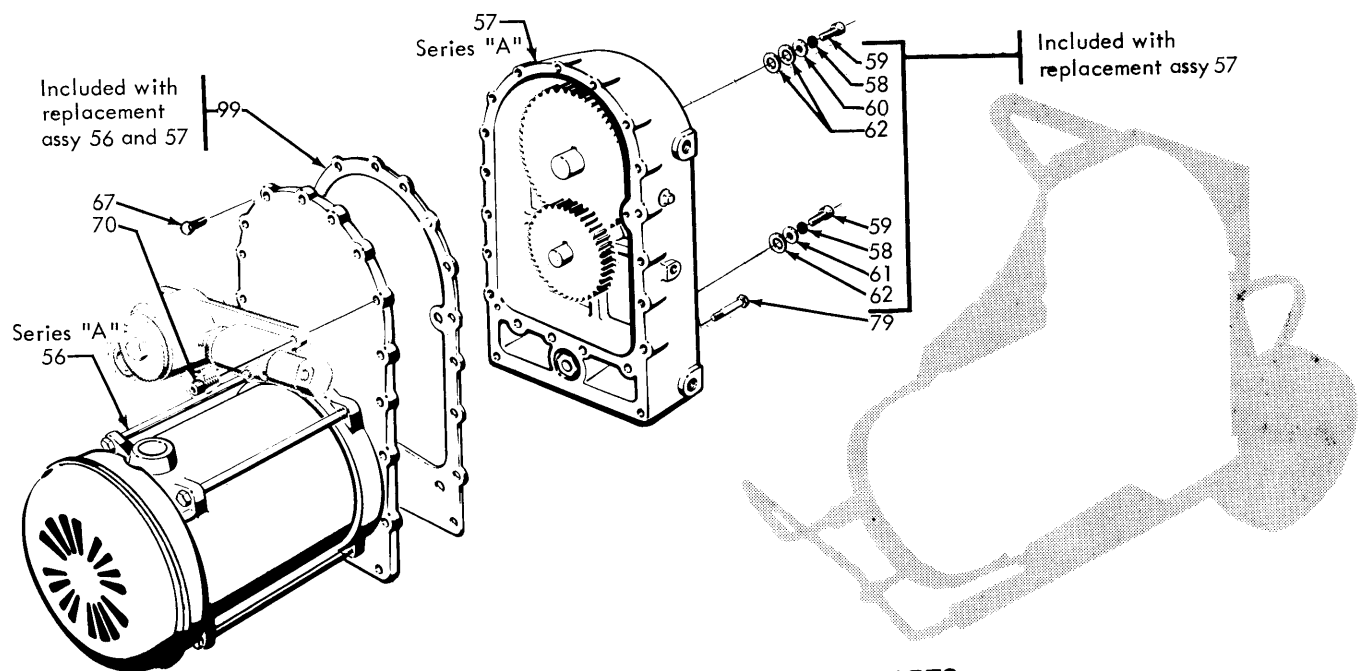
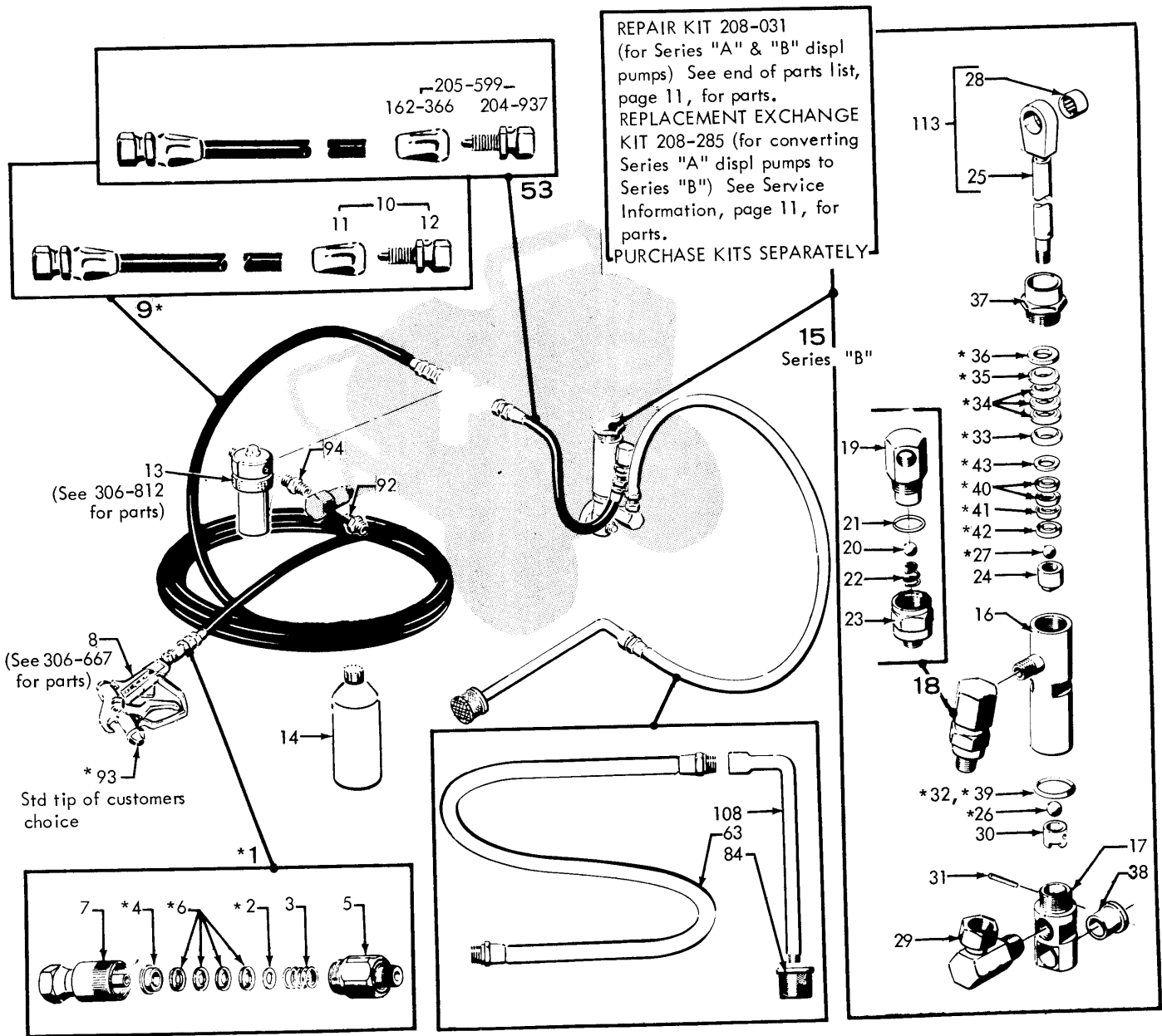

* SUGGESTED REPLACEMENT PARTS

PARTS LIST

226-350 Series "C" PAINT SPRAYER Assy (EM 350)

Includes items 1 thru 63, 66 thru 68, 70, 72 thru 84, 88 thru 96, 98 thru 109, 111, 112

226-361 Series "B" PAINT SPRAYER Assy (EM 350)

Includes items 1 thru 64, 66 thru 68, 70, 72 thru 84, 88 thru 96, 98 thru 103, 105 thru 112

208-035 PAINT SPRAYER Assy (EM 350)

same as 226-350, less items 1, 8, 93

226-365 Series "B" PAINT SPRAYER Assy (EM 350)

Includes items 1 thru 63, 65 thru 81, 84 thru 88, 90 thru 103, 105 thru 109, 111, 112

REF PART NO. NO.	DESCRIPTION	QTY.	REF PART NO. NO.	DESCRIPTION	QTY.
1	*204-940 SWIVEL Assy; $\frac{1}{4}$ npt (m & f) Includes items 2 thru 7	1	44	207-899 PRESSURE CONTROL Assy Series "A" Replaceable parts include items 45 thru 52	1
2	*150-516 . GLAND, male packing	1	45	100-813 . WASHER, flat	2
3	150-522 . SPRING, compression	1	46	101-962 . SETSCREW, soc hd; cup pt; $\frac{1}{4}$ -20 thd; 3/8 lg	1
4	*157-894 . GLAND, female packing	1	47	102-271 . SCREW, rd hd mach; 6-32 thd; 1" lg	2
5	157-898 . ADAPTER, male; $\frac{1}{4}$ npt	1	48	102-888 . RING, backup; "Teflon"	1
6	*162-694 . PACKING, "v" leather	4	49	102-890 . SWITCH, micro; 125 VAC; 20 amp	1
7	204-978 . ADAPTER, swivel; $\frac{1}{4}$ npt (f)	1	50	*168-518 . PACKING, o-ring; viton	1
8	205-591 HYDRA-SPRAY GUN Assy (see 306-667 for parts)	1	51	168-565 . PLUNGER, switch	1
9	*205-616 PAINT HOSE Assy; nylon w/ gnd wire; $\frac{1}{4}$ ID; cpld $\frac{1}{4}$ npsm (f) swivel; 50 ft lg Replaceable parts include items 10 thru 12	1	52	168-596 . CAP, control housing	1
10	205-493 . REUSABLE COUPLING Assy Includes items 11 & 12	2	53	207-907 PAINT HOSE Assy; nylon; $\frac{1}{4}$ ID; 20" lg; cpld $\frac{1}{4}$ npsm (f) swivel See parts drawing for replaceable parts.	1
11	164-625 . . SLEEVE, hose	1	54	207-909 ACTUATOR, switch	1
12	205-494 . . STUD, swivel; $\frac{1}{4}$ npsm (f)	1	55	207-912 CORD SET Assy (for 226-350, 208-035, & 226-365)	1
13	205-888 OUTLET MANIFOLD & FLUID FILTER Assy (see 306-812 for parts)	1	56	207-960 MOTOR & COVER Assy, (for 226-350, Series "A" 208-035 & 226-365) Includes gasket, item 90	1
14	206-994 THROAT SEAL LUBRICANT (1 pt.)	1	208-099	MOTOR & COVER Assy, (for Series "A" 226-361 only) Includes gasket, item 99	1
15	207-891 DISPLACEMENT PUMP Assy Series "B" Includes items 16 thru 43	1	57	208-030 PUMP DRIVE Assy, (for 226-350, Series "A" 208-035 & 226-365) Replaceable parts include items 58 thru 62, 99	1
16	207-888 . CYLINDER, displacement pump	1	208-114	PUMP DRIVE Assy, (for 226-361 Series "A" only) Replaceable parts include items 58 thru 62, 99	1
17	207-889 . HOUSING, intake valve	1	58	100-016 LOCKWASHER, spring, $\frac{1}{4}$ screw size	2
18	208-109 . CHECK VALVE, includes items 19 thru 23	1	59	101-550 CAPSCREW, soc hd, $\frac{1}{4}$ -20 x $\frac{1}{2}$	2
19	208-108 . . VALVE HOUSING	1	60	159-346 WASHER, flat	1
20	101-874 . . BALL, $\frac{1}{2}$ dia. stainless steel	1	61	164-055 WASHER, spacer	1
21	166-702 . . O-RING, nitrile rubber	1	62	168-521 WASHER, thrust	3
22	168-923 . . SPRING	1	63	208-112 SUCTION HOSE; $\frac{1}{2}$ ID; $\frac{1}{2}$ npt; $\frac{3}{4}$ npt (mbe); 22" lg	1
23	168-935 . . ADAPTER, HOUSING	1	64	208-115 CORD SET Assy (for 226-361 only)	1
24	208-268 . HOUSING, valve	1	65	208-159 CABLE, electrical (for 226-365 only)	1
25	208-269 . ROD, displacement	1	66	208-221 FRAME	1
26	*101-947 . BALL, steel; 3/8 dia	1	67	100-021 CAPSCREW, hex hd, $\frac{1}{4}$ -20 thd; 1" lg	9
27	*101-956 . BALL, steel; $\frac{1}{4}$ dia	1	68	100-055 SCREW, drive; type "u"; No. 6 thd size; $\frac{1}{4}$ lg	2
28	102-874 . BEARING, needle	1	69	100-122 NIPPLE, pipe, short, $\frac{1}{2}$ npt (for 226-365 only)	1
29	155-470 . UNION, 90° swivel; $\frac{1}{2}$ npt (mxf)	1	70	100-643 SCREW, soc hd cap; $\frac{1}{4}$ -20 thd; 1" lg	9
30	168-538 . GUIDE, ball	1	71	100-718 LOCKWASHER, internal shakeproof, No. 10 screw size (for 226-365 only)	1
31	168-539 . PIN, ball stop	1	72	100-979 SCREW, self-tapping type "F"; 10-24 thd; 5/16 lg	1
32	*168-540 . WASHER, flat	1 or 2 as needed	73	101-095 CONNECTOR, wire; pressure type No. 14, 16, 18 wire size	1 or 3
33	*168-546 . GLAND, male packing	1			
34	*168-547 . PACKING, "v" leather	3			
35	*168-548 . PACKING, "v" "Teflon"	1			
36	*168-549 . GLAND, female packing	1			
37	168-550 . NUT, packing; w/wet-cup	1			
38	168-659 . BEARING, flanged sleeve	1			
39	*168-718 . WASHER, flat	1 or 2 as needed			
40	*169-428 . PACKING, "v" leather	2			
41	*169-429 . PACKING, "v" "Teflon"	1			
42	*169-430 . GLAND, female packing	1			
43	*169-431 . GLAND, male packing	1			

PARTS LIST (Continued)

REF PART NO. NO.	DESCRIPTION	QTY.	REF PART NO. NO.	DESCRIPTION	QTY.
74 101-421	PIN, cotter; 1/16 dia; 3/8 lg	1	95 166-362	DECAL, "Graco"	1
75 101-894	TERMINAL, wire; for No. 10 wire & No. 10 screw	1	96 167-187	WASHER, flat	2
76 102-472	RIVET, blind	1	97 167-982	PLATE, identification (for 226-365 only)	1
77 102-607	TIP, rubber; switch actuator	1	98 169-804	LABEL, patent	1
78 102-637	CAPSCREW, hex hd; 3/8-16 thd; 1 1/2" lg	4	99 168-531	GASKET, cover	1
79 102-876	CAPSCREW, hex hd; 1/4-20 thd; 3" lg	4	100 168-587	KNOB, shield	2
80 102-893	RING, retaining; external type	2	101 168-589	SHIELD, paint sprayer, EM 350	1
81 102-894	WHEEL, semi-pneumatic	2	102 168-748	DECAL, "EM 350"	1
82 102-940	CONNECTOR, conduit; 90° (for 226-350, 208-035 & 226-361)	1	103 168-749	STRAP, hose	1
83 102-941	ADAPTER, conduit (for 226-350, 208-035 & 226-361)	1	104 168-750	CONDUIT (for 226-350 & 208-035)	1
84 102-952	STRAINER, inlet	1	105 168-751	TRIM	1
85 102-961	ELBOW, electrical; 90° (for 226-365 only)	2	106 168-758	DECAL, pressure control	1
86 103-032	BOX, junction (for 226-365 only)	1	107 168-759	DECAL, on-off switch	1
87 103-035	BUSHING, reducer, electrical (for 226-365 only)	2	108 168-796	TUBE, suction	1
88 103-117	RING, retaining	2	109 168-953	LABEL, warning	2
89 150-707	PLATE, model and serial (for 226-350, 208-035 & 226-361)	1	110 168-954	CONDUIT (for 226-361 only)	1
90 151-395	WASHER, flat	1	111 169-376	SLEEVE, handle	2
91 157-204	WASHER, flat	2	112 169-377	HANDLE	1
92 162-453	NIPPLE, short hex; 1/4-18 thd	1	113 208-348	DISPLACEMENT ROD Assy includes items 25 & 28	1
93 *163-???	SPRAY TIP, std. (customers choice)	1			
94 165-198	NIPPLE, reducing, 3/8 to 1/4 npt	1			

208-031 REPAIR PARTS KIT for Series "A" and "B" displacement pumps. Consists of the following parts:

REF NO.	QTY.	REF NO.	QTY.	REF NO.	QTY.
26	1	34	3	40	2
27	1	35	1	41	1
32	1	36	1	42	1
33	1	39	1	43	1

Also one tube of sealant, part no. 102-969.

NOTE: 306 Numbers in description refer to separate instruction manuals

* SUGGESTED REPLACEMENT PARTS

Order parts by number and name. Also give series letter and model number for which parts are ordered. Call or write your Graco distributor, nearest Graco factory branch or service depot for parts or service.

SERVICE INFORMATION

Listed below by the assembly changed are OLD and NEW parts.

ASSEMBLY CHANGED	PART DESIGNATION	REF PART NO.	PART NO.	NAME
ALL	OLD	207-905		Frame
FINAL ASSY.	NEW	66	208-221	Frame
	OLD		101-831	Pin
	NEW	88	103-117	Retaining Ring
	OLD		168-582	Sleeve
	NEW	111	169-376	Sleeve
	OLD		168-586	Handle
	NEW	112	169-377	Handle
	OLD		167-882	Label
	NEW	98	169-804	Label
207-891	OLD		208-012	Displ. Rod
DISPL. PUMP	OLD		208-013	Piston Valve
	OLD		168-542	Washer
Series to "B"	OLD		168-543	Seal (2)
	OLD		168-544	Retainer (2)
	NEW	25	208-269	Displ. Rod
	NEW	24	208-268	Valve Housing
	NEW	40	169-428	"V" Packing (2)
	NEW	41	169-429	"V" Packing (1)
	NEW	42	169-430	Gland (f)
	NEW	43	169-431	Gland (m)

INTERCHANGEABILITY NOTE: NEW parts replace OLD parts listed directly above them whatever their total.

NOTES

OLD part 208-012 is no longer available - displacement pump Series "A" to "B" conversion kit 208-285 will be substituted and credit allowed for the OLD part 208-012 when returned. 208-285 kit consists of the following parts, assembled and ready for installation.

Ref No.	Qty.	Ref No.	Qty.	Ref No.	Qty.
24	1	35	1	41	1
27	1	36	1	42	1
33	1	37	1	43	1
34	3	40	2	113	1

OLD part 208-013 will be available as a replacement part.

OLD parts 168-542, 168-543 and 168-544 are no longer available - order repair parts kit 208-031. 208-031 kit can be used to repair both Series "A" and Series "B" displacement pumps 207-891.

TECHNICAL DATA

ELECTRIC MOTOR For Model 226-361:
 $\frac{3}{4}$ HP, 1425 RPM, 230 V, 50 Hz, AC,
 single phase with automatic reset thermal
 overload and explosion proof switch.
 For models 226-350 and 226-365:
 $\frac{3}{4}$ HP, 1725 RPM, 115 V, 60 Hz, AC,
 single phase with automatic reset thermal
 overload and explosion proof switch.

ELECTRIC CORD No. 12 ga, 3 wire; use 12 ga(min),
 3 wire extension cord.

PAINT FILTER 60 mesh stainless steel screen with $\frac{3}{8}$ NPT(F)
 inlet and $\frac{1}{4}$ NPT(F) outlets; reusable type.

PAINT PUMP 3000 psi max. working pressure; $\frac{1}{3}$ cpm
 output; 100 cycles per minute.

WETTED PARTS - Nitralloy; Rubber
 impregnated leather; "Teflon"; Steel;
 Stainless Steel.

OPERATING WEIGHT 85 lb. approx.

CSA APPROVAL Model 226-365 is Canadian Standard
 Association approved for hazardous
 location, Class 1, Group D. Do not
 locate unit in spray booth. Use electric
 supply connection at least 20 feet from
 spray gun area.

ACCESSORIES (Must be purchased separately)

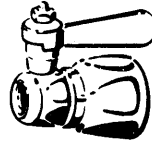

Select-A-Fan 206-310 (with tips)
 fits the fan pattern to both wide
 and narrow surfaces and clears
 tip stoppages.

Gear Oil 208-230

1-quart lube oil for reduction
 gear drive. Gearcase capacity
 is 3 pints.



TSL Throat Seal Lubricant

206-995 1 quart non-evaporation
 solvent for wet cup.
206-996 1 gallon size.

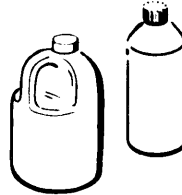

12 Gauge Extension Cord Sets

102-652 25 FT. LENGTH

102-653 50 FT. LENGTH



Static Grounded Nylon Hose 205-492

Part No. I.D. Lg. Thd. size
 205-492 $\frac{1}{4}$ " 25' $\frac{1}{4}$ NPSM (F)

(Use only in addition to standard 50 ft hose)



DIMENSIONAL DRAWING

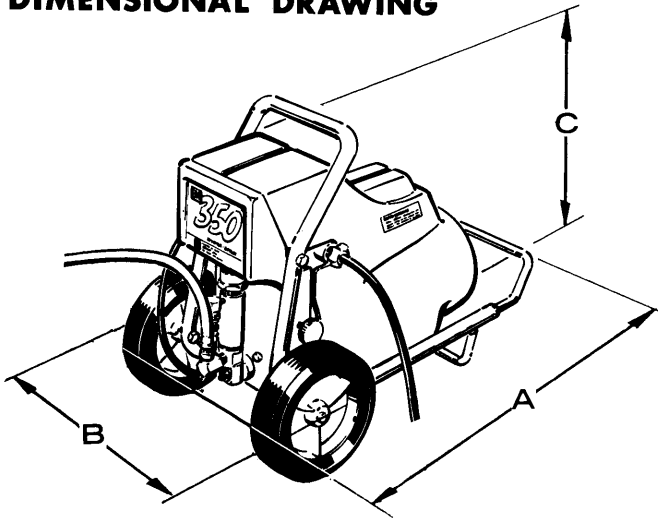

A Length 26 $\frac{1}{2}$ "

B Width 14 $\frac{3}{4}$ "

C Height 20"

THE GRACO WARRANTY

Based on the logical assumption that manufacturing and material deficiencies will manifest themselves within twelve months' time, Graco Inc. warrants all equipment manufactured by it and bearing its name to be free from defects in material and workmanship under normal use and service. Scope of this warranty extends to the original purchaser for a period of 12 months from the date of purchase and is applicable only when the equipment is installed and operated in accordance with factory recommendations. The warranty does not extend to damage or wear caused by misuse, abrasion, corrosion, negligence, accident, faulty installation or tampering in a manner to impair its normal operation.

In the event the equipment supplied by Graco Inc. is found to be defective within the above-stated 12-month period, Graco Inc. will repair or replace free of charge such defective parts if rendered prepaid to the factory or to an authorized Graco service agency and is found by Graco Inc.'s inspection to be truly defective in workmanship or material. In the event said material is deemed defective in workmanship or material it will be corrected and shipped transportation prepaid within the continental U.S. If inspection of any such equipment by Graco Inc. does not disclose any defect in workmanship or material, repairs will be made at a reasonable charge. Purchased assemblies which are incorporated into Graco equipment, carry the manufacturer's regular warranty.

The foregoing warranties are exclusive, and are in lieu of all other warranties (whether written, oral or implied) including warranty of merchantability in other respects than expressly set forth above and warranty of fitness for a particular purpose. Except as herein provided, every form of liability for direct or consequential damages or loss is expressly excluded and denied.



Factory Branches: ATLANTA, CHICAGO (Broadview), CLEVELAND, DALLAS, DETROIT (Southfield),
 FT. LAUDERDALE, HOUSTON, LOS ANGELES, PHILADELPHIA (Levittown), ST. LOUIS
 (Maryland Heights), SOUTH SAN FRANCISCO, WEST CALDWELL (N.J.)

**Subsidiary and
 Affiliate Companies:** BUENOS AIRES, CARACAS and SAO PAULO, S.A.; DUSSELDORF, GER; GENEVA, SWITZ;
 HONG KONG; LONDON, ENG; MYENNES and PARIS, FR; TOKYO, JA; TORONTO, CAN.

GRACO INC. P.O. BOX 1441 Minneapolis, MN 55440

306-999
 Aug., 1969
 Revised
 Oct., 1971
 PRINTED
 IN
 U.S.A.